

## 1969 CAMARO OEM REPRODUCTION DASH PAD (With or Without AC)

**Important: Please read the entire installation instruction procedure before attempting installation.** This dash pad was designed for professional installation, The directions offered are a simple overview of the installation procedure. For best results, we highly recommend professional installation. Please refer to an assembly manual for more detailed information.

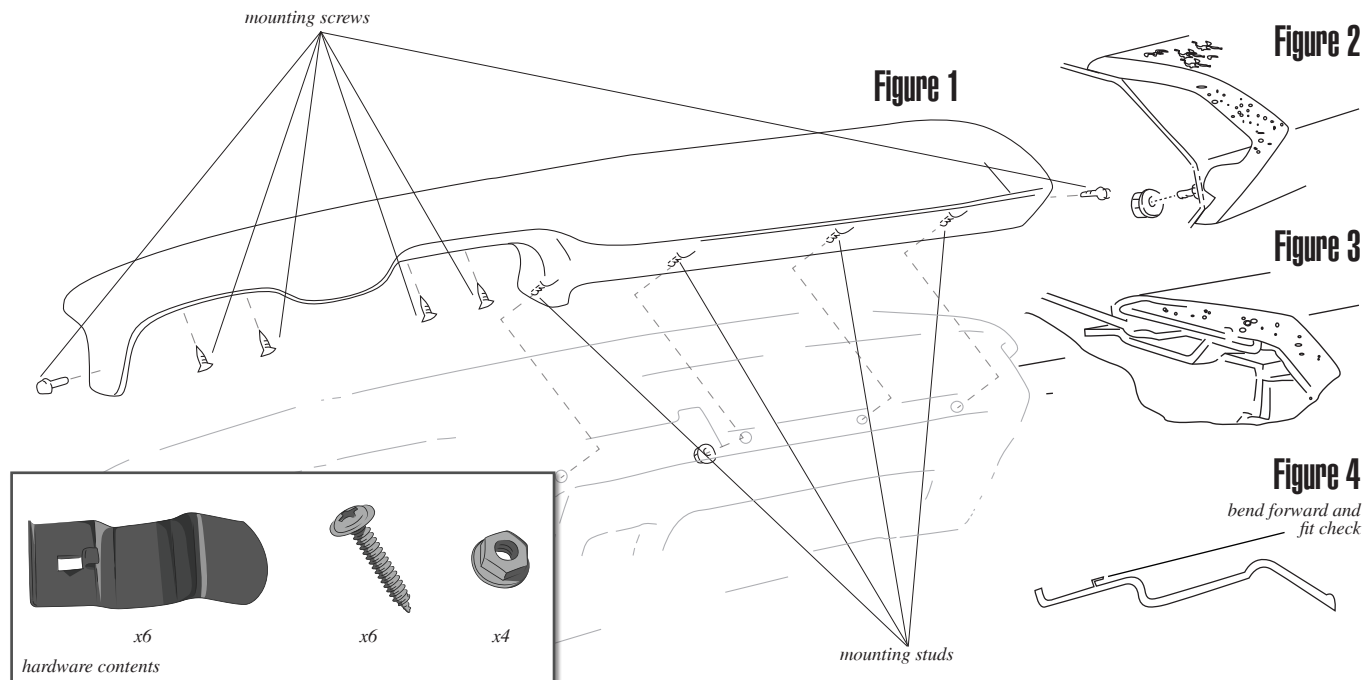

### Installation Package Includes

- (1) OEM Style Dash Pad
- (6) Dash Pad Mounting Clips
- (6) Mounting Screws
- (4) Flange Nuts

### Step 1

Disconnect the negative terminal on the car battery. This is critical to prevent the possibility of shorting out the electrical system when disconnecting gauges or other wiring and will also prevent the possibility of electrical shock.

### Step 2

The original dash pad is mounted with 6 mounting clips, 4 nuts and washers, and 6 screws. There is a clip on each side of the dash pad and two to each side of the center area designated for the dash clock (Figure 1). Remove all nuts, washers and screws. It may be necessary to remove the ashtray and the glove box liner to reach the nuts that are attached to the studs on the dash pad (Figure 2). It is not necessary to remove the gauge cluster. With all clips, washers, nuts and screws removed, lift the front edge of the dash pad up toward the headliner and slide back toward the rear seat at the same time. This will disengage the four mounting clips (Figure 3) that hold the back edge of the dash pad. Lift up and out to remove the dash pad from the vehicle. Removal is now complete.

### Step 3

Place the dash pad top down on a soft, flat surface. Check the fit of the 6 clips on the new dash pad. Adjust the clips with needle nose pliers by bending the small tab on the clip as indicated in (Figure 4). A small amount of force is required to snap them into place. New clips are available, OER Part# \*R849.

### Step 4

Place your new dash pad on top of the dash frame. Align the 6 clips with the 6 slots in the frame and push forward. Note: Take extra care to be sure each of the clips is aligned. Failure to align the clips correctly could scratch or mar the paint on the dash frame, which cannot be repaired without removing the windshield. Push the face of the dash pad forward, allowing the 4 studs to align. Install the two screws, one on each side of the dash pad, with the new provided hardware. It is not necessary to over tighten these screws. Utilizing the new nuts and washers provided with your new dash, secure the dash pad in place, slowly tightening to snug the dash pad to the frame. It is not necessary to over tighten the nuts. Finish by tightening the four front screws removed from the original dash pad.

### Step 5

After the dash pad is installed and secure, reconnect any under dash wiring or brackets. Reconnect your battery and be sure to test all connections. Consult a wiring diagram should any electrical problems occur.

### Proper Painting of Dash Pad

**Important:** Be sure to fit the dash pad onto the dash assembly before painting or altering the dash pad.

1) Clean & prep in accordance with the products label instructions. Be sure the surface is clean, dry and free of all debris and contaminants.  
**OER Part# PP1009 - Prep Cleaner**

2) Use adhesion promoter, that's designed for flexible surfaces.  
**OER Part# PP215 - Adhesion Promoter**

3) Once the adhesion promoter is set, continue with a urethane primer designed for flexible surfaces. **OER Part# PP618 - Urethane Primer**

**Note:** Allow ample time for primer to completely cure before painting.

4) Once the primer is cured continue to paint with desired color of choice. **OER® offers several original colors to choose from.**

**Note:** Allow ample time for paint to completely cure before beginning installation.

### Manufacturer's Note

Be sure to fit the dash pad onto the dash assembly before painting or altering the dash pad. Painting or altering the dash pad in any way could result in voiding the warranty. Please follow instructions carefully when installing to ensure proper fit.

**Note:** OER® and its distributors are not responsible for incorrect installation of the dash pad.