



1970-72 Chevelle Pro Touring Spoiler Installation Instructions

Installation Instructions

Before installing your Addictive Flow product(s), read through the entire installation procedure and check to make sure all items are present. Contact Customer Service 9:00 AM to 5:00 PM weekdays, for any questions regarding fit or instructions that are unclear to you.

SAFETY REQUIREMENTS

**STOP! READ IMPORTANT SAFETY CAUTIONS AND WARNINGS BEFORE PROCEEDING.
IMPORTANT SAFETY NOTICE.**

Appropriate disassembly, assembly methods and procedures are essential to ensure the personal safety of the individual performing the kit installation. Improper installation due to the failure to correctly follow these instructions could cause personal injury or death. Read each step of the installation manual carefully before starting the actual installation.

1. Always wear safety glasses for eye protection.
2. Place ignition switch in the OFF position or disconnect battery.
3. Always apply the parking brake when working on a vehicle.
4. Block/Chock the front and rear tire surface to prevent unexpected vehicle movement.
5. If working without a lift, always consult vehicle manual for correct lifting specifications.
6. Operate the engine only in well-ventilated areas to avoid exposure to carbon monoxide.
7. Keeps hands and any other objects away from the radiator fan blades.
8. Do not wear loose clothing or jewelry that can get caught in rotating parts or scratch surface finishes.
9. Allow the engine, cooling system, brakes and exhaust to cool before working on a vehicle.
10. WORK SAFELY!

Packing List for Installation of Spoiler

- (2) 5/16" J-Clip
- (1) L -Bracket
- (1) #14 Screw
- (2) 5/16" Bolt w/ Washer
- (1) 2293 Clip

Please be sure to check that all the items are present before installation. If anything is missing contact customer service.

Important Notice: In some instances, your spoiler may arrive and look warped or twisted. This is because we have designed our spoilers to be forgiving, that way if you accidentally hit a curb or hit a steep incline the spoiler will give as opposed to shattering or damaging the car. If your spoiler seems a bit off simply let it rest overnight and it will regain its correct form. In rare instances you may have to slightly heat the material with a heat gun. In most cases; however, the spoiler will take its correct form when mounted to the car. If you have any questions, please call customer service.

U.S. & Canada: (866) 358-2277

International: (203)-235-1200

Monday – Thursday: 9:00 AM – 5:00 PM (ET) **Friday:** 9:00 AM – 2:00 PM (ET) **Saturday:** 9:00 AM – 1:00 PM (ET)



1. Mock-up

Since these cars were originally built by hand on an assembly line, no two cars are identical. Because of this we do not predrill holes in our spoilers as there is a potential for it not lining up correctly on your vehicle.

a. To begin you must first attach the included L bracket (A) so you can get a correct center point on your spoiler. Attach the included L Bracket to the to the hood latch support (C) by removing the factory bolt from the hood latch support, sliding the L Bracket behind the hood latch support, and reattaching the factory bolt. The L Bracket should be positioned so the longer end is vertical. See image (B) below of how this should look on a 1970 Hood Latch Support.

b. Clamp the spoiler to your front end and begin aligning it to your liking. We found it best to clamp down the ends of the spoiler to the fender extensions and begin tweaking it slightly until its centered.

c. Once the spoiler is positioned to your liking mark the spots on the spoiler for you to drill your attaching holes. We found through testing that all you need is 3 anchor points. One should be the center mark using the L Bracket and the other 2 should be at the ends.

You should utilize the fender brace holes to mark your end holes.

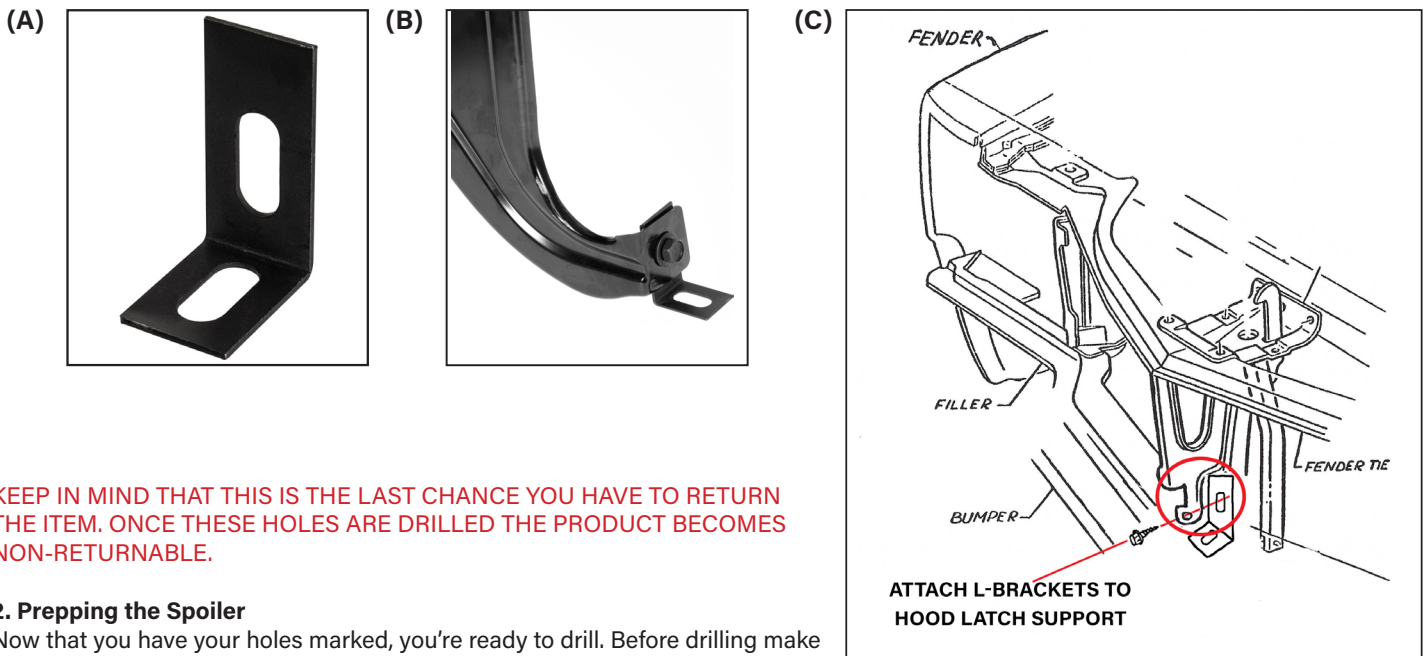

KEEP IN MIND THAT THIS IS THE LAST CHANCE YOU HAVE TO RETURN THE ITEM. ONCE THESE HOLES ARE DRILLED THE PRODUCT BECOMES NON-RETURNABLE.

2. Prepping the Spoiler

Now that you have your holes marked, you're ready to drill. Before drilling make sure your measurements are correct. We also recommend using a small drill bit first and working your way up in size as needed. Keep in mind that the end holes will have to be larger than the center to accommodate the factory 5/16" fender bolts. Less is definitely more when it comes to this step.

3. Installation

Now that your holes are drilled out and your L bracket is installed, you're ready to begin installation. Opposite from the mock-up phase we recommend attaching the center first and working you're way out to the ends

a. Using the included hardware (2293 Clip & #14 screw) attach the center of the spoiler to the recently installed L bracket. Do not tighten this fully until each mounting point is loosely installed. We found it easier to use clamps to hold the spoiler ends in place while you install the center.

b. Attach the ends of your spoiler directly into the Fender Extensions. You can reuse the factory 5/16" bolts and anchor it directly into the fender braces. *If you don't have fender braces on your car you can utilize included j-clips.*

c. Now that the spoiler is loosely installed take a step back and make any final adjustment needed to the spoiler.

d. Once you are satisfied by the look return to the car and tighten down each bolt.