

BRAKE KITS

BEST SELLER! \$AVE BIG!

Front Power Disc Brake Conversion Kits

Upgrade your GM-A body today with the most complete front disc brake kit on the market. Includes all OEM parts and is available with multiple upgrades. Increase stopping power and give your car that factory stock disc brake appearance. Works with 15" wheels or larger. Includes;

- 11" Rotors
- Forged Spindles
- Bearings & Seals
- Loaded Calipers
- Caliper Brackets
- Backing Plates
- Flex Hoses & Clips
- Master Cylinder
- Power Booster (9" or 11" Gold)
- Combination Valve & Bracket
- All Hardware

FM-1790AS	1964-72 GM-A body with 11" Booster	583.85 kit
FM-1790AS9	1964-72 GM-A body with 9" Booster.....	583.85 kit
FM-1790DSA	1964-72 GM-A body	
	2" Drop Spindle-11" Booster.....	618.57 kit
FM-1790DSA9	1964-72 GM-A body	
	2" Drop Spindle-9" Booster	613.39 kit



SHOW N'GO UPGRADE

This package adds drilled and slotted rotors and red or black powder coated calipers.

FM-1790AS-UP-S	D/B Kit with Show N Go Black.....	614.83 kit
FM-1790AS-UP-Z	D/B Kit with Show N Go Red	614.83 kit
FM-1790DSS	2" Drop Kit-11" w/ Show N Go Black.....	711.99 kit
FM-1790DSZ	2" Drop Kit-11" w/ Show N Go Red.....	711.99 kit

1973-77 Front disc upgrade to drilled and slotted rotors with powder coated calipers.

This kit contains the rotors and calipers only.

AFXWK70DS	1973-77 Black Calipers	562.99 kit
AFXWK70DZ	1973-77 Red Calipers.....	562.99 kit



BEST OF SHOW UPGRADE

Adds drilled & slotted rotors, 8" chrome master, booster, pro-valve assembly and powder coated calipers.

FM-1790AS-UP-SX	D/B Kit with Best of Show Black.....	716.66 kit
FM-1790AS-UP-ZX	D/B Kit with Best of Show Red	716.66 kit
FM-1790DSX	2" Drop Kit- w/ Best of Show Black	742.99 kit
FM-1790DZX	2" Drop Kit- w/ Best of Show Red.....	742.99 kit

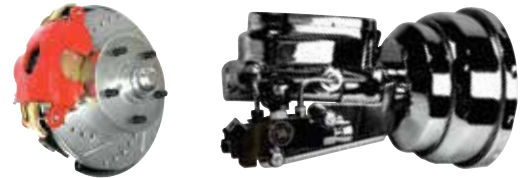

SHOW STOPPER UPGRADE

Adds drilled & slotted rotors and a chrome master, booster, pro-valve assembly

FM-1790AS-UP-X	D/B Kit with Show Stopper Chrome.....	675.64 kit
----------------	---------------------------------------	------------



KEEP YOUR FACTORY 14" WHEELS – POWER FRONT DISC BRAKE KITS

Half the install time & no alignment needed- Bolts directly to stock drum spindles, fits any 14" wheel, uses a proprietary rotor. Includes booster, master, combo valve, rotors, calipers, brackets and hardware.

AFXDC14-11	1964-72 Chevelle 11" Power Booster	517.99 kit
AFXDC14-9	1964-72 Chevelle 9" Power Booster	517.99 kit
AFXDC14-A	1964-72 Chevelle 9" Booster D/S Rotors	562.99 kit
AFXDC14-C	1964-72 Chevelle 8" Chrome Booster	645.95 kit



DISC BRAKE CONVERSION LINE KITS – NO BRAINER

Simplify your installation with all the brake lines and clips you will need. Includes: • Front line kit • Front to Rear line • Rear axle line set • Rear flex hose • Clip set

		Original	Stainless
C64DCKIT_ *_*_*	1964-67 Chevelle Hardtop	117.99 kit.....	160.99 kit
C64VDCKIT_ *_*_*	1964-67 Chevelle Convertible.....	117.99 kit.....	160.99 kit
C68DCKIT_ *_*_*	1968-72 Chevelle Hardtop	117.99 kit.....	160.99 kit
C68VDCKIT_ *_*_*	1968-72 Chevelle Convertible.....	117.99 kit.....	160.99 kit

Add these to the part #'s* above for the following:

*M - Manual brakes-No Power booster used *4- For 4 wheel disc brakes *SS - For stainless steel lines

BRAKE CONVERSION KITS

TRSD Performance Series Disc Brake Conversions

These all new disc brake conversions from The Right Stuff feature Wilwood 2 piston calipers, street performance brake pads, stainless braided flex hoses, spindles, caliper brackets, dust shields, proportioning valve, brake booster with master cylinder and factory size drilled and slotted rotors making for a super easy installation. These kits fit with most 15" or larger wheels.



Street Performance Series Upgrade Featuring Wilwood Calipers

The Right Stuff Detailing's new Street Performance Series front disc brake upgrade kit is an easy way to add a nice finishing touch to your car. This kit features Wilwood dual piston black powder coated calipers, fully loaded with pads and hardware, drilled & slotted rotors and spindles. No booster, master cylinder or pro-valve included. Installation hardware and instructions are included.

4 Wheel Kits

4 Wheel Kits Stock Height

AFXSD21CS	1964-72 Black Calipers Manual	1462.99 kit
AFXSD21CZ	1964-72 Red Calipers Manual	1462.99 kit
AFXDC21CS	1964-72 Black Calipers 9" Gold Booster	1525.99 kit
AFXDC21CZ	1964-72 Red Calipers 9" Gold Booster	1525.99 kit
AFXDC26CS	1964-72 Black Calipers 11" Gold Booster.....	1525.99 kit
AFXDC26CZ	1964-72 Red Calipers 11" Gold Booster	1525.99 kit
AFXSD21CSX	1964-72 Black Calipers Manual Chrome Master	1507.99 kit
AFXSD21CZX	1964-72 Red Calipers Manual Chrome Master.....	1507.99 kit
AFXDC21CSX	1964-72 Black Calipers 8" Chrome Booster.....	1570.99 kit
AFXDC21CZX	1964-72 Red Calipers 8" Chrome Booster	1570.99 kit

2" Drop Spindle

AFXSD21DS	1964-72 Black Calipers Manual	1498.99 kit
AFXSD21DZ	1964-72 Red Calipers Manual	1498.99 kit
AFXDC21DS	1964-72 Black Calipers 9" Gold Booster	1561.99 kit
AFXDC26DZ	1964-72 Red Calipers 9" Gold Booster	1561.99 kit
AFXDC26DS	1964-72 Black Calipers 11" Gold Booster.....	1561.99 kit
AFXDC26DZ	1964-72 Red Calipers 11" Gold Booster	1561.99 kit
AFXSD21DSX	1964-72 Black Calipers Manual Chrome Master	1543.99 kit
AFXSD21DZX	1964-72 Red Calipers Manual Chrome Master.....	1543.99 kit
AFXDC21DSX	1964-72 Black Calipers 8" Chrome Booster.....	1606.99 kit
AFXDC21DZX	1964-72 Red Calipers 8" Chrome Booster	1606.99 kit

Front End Kits Stock Height

AFXDC32S	1964-72 Black Calipers 11" Gold Booster.....	895.99 kit
AFXDC32Z	1964-72 Red Calipers 11" Gold Booster	895.99 kit
AFXDC32SX	1964-72 Black Calipers 8" Chrome Booster.....	990.99 kit
AFXDC32ZX	1964-72 Red Calipers 8" Chrome Booster	990.99 kit

Front End Kits 2" Drop Spindle

AFXDC32DS	1964-72 Black Calipers 11" Gold Booster.....	931.99 kit
AFXDC32DZ	1964-72 Red Calipers 11" Gold Booster	931.99 kit
AFXDC32DSX	1964-72 Black Calipers 8" Chrome Booster.....	1026.99 kit
AFXDC32DZX	1964-72 Red Calipers 8" Chrome Booster	1026.99 kit

Front End Upgrade Kits

These kits come with drilled and slotted rotors, calipers, spindles and hardware.

AFXWK32S	1964-72 Black Calipers Stock Height.....	733.99 kit
AFXWK32Z	1964-72 Red Calipers Stock Height.....	733.99 kit
AFXWK32DS	1964-72 Black Calipers 2" Drop Spindle.....	774.99 kit
AFXWK32DZ	1964-72 Red Calipers 2" Drop Spindle.....	774.99 kit

These kits come with drilled and slotted rotors, loaded calipers and hardware.

RCP69S	1964-72 Black Calipers	614.99 kit
RCP69Z	1964-72 Red Calipers	614.99 kit

Rear End Kits

AFXRDM21S	1964-72 Black Calipers	652.99 kit
AFXRDM21Z	1964-72 Red Calipers	652.99 kit
AFXRDM278S	1978-88 Black Calipers	706.99 kit
AFXRDM278Z	1978-88 Red Calipers	706.99 kit

Rear Kits With Front Upgrade Kits

These kits come with a complete rear kit and a front kit with drilled and slotted rotors, loaded calipers and hardware.

A69RDM21S	1969-72 Black Calipers	1215.99 kit
A69RDM21Z	1969-72 Red Calipers	1215.99 kit
A73RDM21S	1973-77 Black Calipers	1215.99 kit
A73RDM21Z	1973-77 Red Calipers	1215.99 kit
A78RDM278S	1978 Black Calipers	1278.99 kit
A78RDM278Z	1978 Red Calipers	1278.99 kit
A79RDM278S	1979 Black Calipers	1278.99 kit
A79RDM278Z	1979 Red Calipers	1278.99 kit
A82RDM278S	1982-88 Black Calipers	1278.99 kit
A82RDM278Z	1982-88 Red Calipers	1278.99 kit

These kits ship oversize. No Volume Discount.



AFDC32S



AFDC32SX



RCP69Z

AFXRDM21S



A69RDM21S

AFXWK32DZ



AFXDC41CZX

BUY'N SAVE
WITH KITS



Four Wheel Power Disc Brake Conversion Kits

Upgrade your classic to the ultimate in stopping power. Our 4 wheel kits are the most complete kits in the industry at rock bottom prices. Upgrade packages available- see ledger below. Add our No Brainer Disc Brake line kit for a care-free installation.

Stock Height

AFXDC41C	1964-72 Chevelle 9" PB	895.99 kit
AFXDC46C	1964-72 Chevelle 11" PB	895.99 kit
AFXDC41CS	1964-72 Chevelle 9" PB, DS, BPC.....	1102.99 kit
AFXDC46CS	1964-72 Chevelle 11" PB, DS, BPC.....	1102.99 kit
AFXDC41CZ	1964-72 Chevelle 9" PB, DS, RPC.....	1102.99 kit
AFXDC46CZ	1964-72 Chevelle 11" PB, DS, RPC.....	1102.99 kit
AFXDC41CSX	1964-72 Chevelle 8" CH, DS, BPC	1170.99 kit
AFXDC41CZX	1964-72 Chevelle 8" CH, DS, RPC	1170.99 kit

2" Dropped Spindle Height

AFXDC41D	1964-72 Chevelle 2" Drop w/ 9" PB	945.99 kit
AFXDC41DS	1964-72 Chevelle 2" Drop, 9"PB, DS, BPC.....	1152.99 kit
AFXDC41DSX	1964-72 Chevelle 2" Drop, 9"CH, DS, BPC	1219.99 kit
AFXDC46D	1964-72 Chevelle 2" Drop w/ 11" PB	945.99 kit
AFXDC46DS	1964-72 Chevelle 2" Drop, 11"PB, DS, BPC	1152.99 kit
AFXDC46DSX	1964-72 Chevelle 2" Drop, 11"CH, DS, BPC.....	1219.99 kit

*PB- Gold Power Booster, DS- Drilled & Slotted Rotors, BPC-black powder coated calipers, RPC-red powder coated calipers CH-Chrome power assembly (booster, master, pro-valve)



AFXDC46C-GUPX



AFXDC4WDS11-GUPX

1964-1972 Chevelle Ground Up Exclusive 4 Wheel Disc Brake Conversions

Upgrading your Chevelle to four-wheel disc brakes is one of the easiest and most cost-effective things you can do for more driving enjoyment and increased safety. Classic Chevelles had great performance and styling from the factory but left a lot to be desired in the braking department. Upgrade your outdated braking system today with this convenient Ground Up Exclusive four-wheel disc brake kit and cruise with peace of mind. This kit is complete with a front brake kit and a rear brake kit.

AFXDC46C-GUPX	1964-72 All 11" PB.....	719.96 kit
AFXDC41C-GUPX	1964-72 All 9" PB.....	769.99 kit
AFXDC4WDS09-GUPX	1964-72 All 9" PB DS Rotors SS Flex Hoses.....	775.96 kit
AFXDC4WDS11-GUPX	1964-72 All 11" PB DS Rotors SS Flex Hose.....	775.96 kit

Note: This kit requires 15 inch diameter wheels or larger. Rear kit will not fit 14.5 inch inner diameter wheels such as reproduction Super Sport / Olds SSI wheels. Will fit 15 inch or larger rally wheels or aftermarket aluminum Super Sport wheels.

SIGNATURE* BY TRSD 4-WHEEL DISC BRAKE CONVERSION KITS
***FOR 17" OR LARGER WHEELS • LIFETIME WARRANTY!!!**

Bold looks define the Signature line of Brake Kits. Large diameter (13") zinc plated rotors, powder coated calipers and USA made Timken bearings: Only premium quality components make the grade. These are amazing brakes at a great price. Add the No Brainer Brake Line Kit for true bolt-in installation. Requires minimum 17" wheel. Bolts to stock drum or disc spindles. Complete kit includes:

- 13" Front drilled/slotted zinc plated rotors • 12" rear drilled/slotted zinc plated rotors • Fully machined caliper brackets
- 2024-Tk Forged aluminum hubs w/ 7/16" and 1/2" studs for multiple apps • Twin piston aluminum powder coated calipers- red or black
- Ceramic brake pads • Braided stainless steel hoses • Integrated parking brake
- Premium quality hardware • OEM style master cylinder w/combination valve • Chrome master/booster/ valve upgrade available.

*PB- Gold Power Booster, DS- Drilled & Slotted Rotors, BPC-black powder coated calipers, RPC-red powder coated calipers CH-Chrome power assembly (booster, master, pro-valve)

STOCK HEIGHT SIGNATURE KITS (Reuse Original Spindles)

AFXDC51CS	1964-72 Chevelle w/ PB, DS, BPC.....	1462.99 kit
AFXDC51CZ	1964-72 Chevelle w/ PB, DS, RPC.....	1462.99 kit
AFXDC51CSX	1964-72 Chevelle w/ PB, DS, BPC, CH*	1557.99 kit
AFXDC51CZX	1964-72 Chevelle w/ PB, DS, RPC, CH*	1557.99 kit

2" DROPPED SIGNATURE KITS

AFXDC51DS	1964-72 Chevelle w/ PB, DS, BPC.....	1620.99 kit
AFXDC51DZ	1964-72 Chevelle w/ PB, DS, RPC.....	1620.99 kit
AFXDC51DSX	1964-72 Chevelle w/ PB, DS, BPC, CH*	1714.99 kit
AFXDC51DZX	1964-72 Chevelle w/ PB, DS, RPC, CH*	1714.99 kit

4 WHEEL DISC BRAKE CONVERSION LINE KITS - "NO BRAINER" (Reuse Original Spindles)

Simplify your installation when doing a 4-wheel disc brake conversion with all the brake lines and clips you will need. Includes: Front line kit, Front to Rear line, Rear axle line set, Rear flex hoses, Clip set.

	Original	Stainless
C64DCKIT4_*	1964-67 Chevelle Hardtop 4W D/B Lines.....	125.99 kit / 160.99 kit
C64VDCKIT4_*	1964-67 Chevelle Convertible 4W D/B Lines.....	117.99 kit / 160.99 kit
C68DCKIT4_*	1968-72 Chevelle Hardtop 4W D/B Lines.....	117.99 kit / 160.99 kit
C68VDCKIT4_*	1968-72 Chevelle Convertible.....	117.99 kit / 160.99 kit

*Add *SS to Part # for Stainless lines



AFXDC51CSX



C64DCKIT4



AFXRD01

Rear Disc Brake Conversion Kit

Complete rear disc brake conversion kit for the ultimate stopping power. This kit includes rotors, loaded calipers, caliper brackets, bracket hardware, flex hoses and rear brake cables.

To add drilled and slotted rotors and painted calipers, add the following letters.

S for Black Calipers, Z for Red Calipers.

Ex. AFXRD01S is 1964-72 w/ Black Calipers.

AFXRD01_* 1964-72 Standard Calipers 490.99 kit
 No Volume Discount. Ships in multiple Oversize boxes.

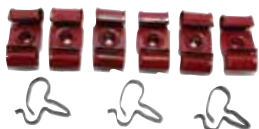

INL-CAB201

Brake Line Clip Kits - O.E.M.

These complete brake line clip kits include all of the factory correct clips in the original colors.

INL-CAB201	1964-66 Brake Line Clip Kit (9 pc.)	26.99 kit
INL-CAB202	1967 Brake Line Clip Kit (10 pc.)	26.99 kit
INL-CAB203	1968 Brake Line Clip Kit (15 pc.)	30.99 kit
INL-CAB204	1969 Brake Line Clip Kit (19 pc.)	30.99 kit
INL-CAB205	1970 Brake Line Clip Kit (19 pc.)	30.99 kit
INL-CAB206	1971-72 Brake Line Clip (23 pc.)	39.99 kit
INL-ACB202	1973-77 Brake Line Clip (23 pc.)	44.99 kit



FSK-69KIT

Deluxe Disc Brake Mini Kit

This deluxe disc brake mini kit contains essential parts to convert to your own disc brake setup or refurbish your factory setup. Includes spindles, caliper brackets, caliper backing plates, flex hoses, pro valve kit, bearing and seal kit and hardware.

FSK-69KIT 1969-72 w/ Single Piston Calipers..... 219.99 kit

Can be used on 1964-1968 when using 69-72 single piston calipers. No Volume Discount.



FSK-69

Basic Disc Brake Mini Kit

Basic kit for converting to disc brakes or restoring factory disc brake setup. Complete with 2 spindles, 2 caliper brackets, 2 caliper backing plates and 2 bolts.

FSK-69 1969-72 209.49 kit

Can be used on 1964-1968 when using 69-72 single piston calipers. No Volume Discount.

BRAKE HARDWARE



Powdercoated Calipers

Add a nice finishing touch with these loaded calipers complete with pads and hardware.

FRC-69AR	1969-72 Red	169.99 kit
FRC-69AB	1969-72 Black.....	169.99 kit
FRC-73AR	1973-77 Red.....	170.99 kit
FRC-73AB	1973-77 Black.....	170.99 kit



FMP-0200

Disc Brake Pads

New brake pad set.

FMP-0400	1967-68 4 Piston	49.99 set
FMP-0200	1964-72 1 Piston	36.95 set

BRAKE HARDWARE *continued*



EVP01

Electric Vacuum Kit

If you have a big cam and low vacuum is making it tough for your power disc brakes to work properly, then this electric vacuum pump kit will solve your problems! This kit includes an efficient electric pump, relay switch, distributor with vacuum switch, wiring, hoses and brackets. This system requires a 12V negative ground system for operation.

EVP01 Vacuum Pump Kit 267.99 kit



FBK-67D

Bearing & Seal Kit

New GM bearing & seal kit (2) inners, (2) outers, and (2) grease seals.

FBK-67D 1964-72 All w/ Disc.....46.53 kit



FBC-605

Bearing Cap

Original GM style bearing & dust shield cap.

FBC-605 1964-72 All 9.99 ea.



FNW-103

Bearing Nut -Washer Kit

Correct castle nut, thrust washer and cotter pin. 2 kits are required per car.

FNW-103 1964-72 All 4.99 kit



FMM-1021

Single Piston Brake Calipers

New single piston loaded calipers complete with pads and all new hardware. Ready to install!

FMM-1021	1964-72 LH	79.95 ea.
FMM-1022	1964-72 RH	79.95 ea.
FRC-12N	1978-88 LH	64.99 ea.
FRC-13N	1978-88 RH	64.99 ea.

No Volume Discount.



FKW-4160

Caliper Backing Plates

Reproduction zinc backing plates.

FKW-4160	1967-68 4 Piston	70.99 pr.
FPP-11J	1964-72 Single Piston	39.95 pr.
FPP-11GSK	1969-72 Gasket	3.99 pr.

No Volume Discount.



CFC6701

Caliper Inlet Lines

Correct lines for 4 piston calipers. Choose original material or stainless steel.

1/2" RH Port & 7/16" LH Port

CFC6701	1967-68 OM	19.99 pr.
CFC6701SS	1967-68 SS	25.99 pr.

3/8" LH Port & 3/8" RH Port

CFC6702	1967-68 OM	19.99 pr.
CFC6702SS	1967-68 SS	25.99 pr.



FHB-01

Inlet Line Brackets

Correct 4 piston caliper inlet line brackets which mount to the calipers where the hard inlet lines meet the rubber flex hoses.

FHB-01	1967	33.99 pr.
FHB-02	1968	20.99 pr.



FM-2501

Caliper Mounting Brackets

Reproduction caliper mounting brackets.

FM-155X	1967-68 4 Piston	133.99 pr.
FM-2501	1964-72 Single Piston	69.95 pr.

BCP-373

Backing Plate Bolt

Correct bolt for attaching plate to spindle.

BCP-373	1964-72 Single Piston	2.99 ea.
---------	-----------------------------	----------



BMP-1000

Brake Caliper Bolts

Correct bolts/pins for mounting caliper to bracket. Two per caliper.

BMP-1000	1964-72 Single Piston	2.99 ea.
----------	-----------------------------	----------



FBP-035

Disc Brake Retaining Pin

Correct pin for retaining 4 piston caliper brake pads to caliper. 2 required.

FBP-035	1967-68 4 Piston	4.99 ea.
---------	------------------------	----------



FSA-01

Steering Arms

Reproduction steering arms for your worn or missing originals.

FSA-01	1964-72	76.99 pr.
--------	---------------	-----------

FM-373B



FM-3712

Spindles

New OEM spindles.

FM-3712	1964-72 Disc	72.99 ea.
FM-1712	1964-72 Drum	95.95 ea.
FM-37DROP	1964-72 Disc Brake Drop Spindles.....	169.00 pr.
FM-373B	Attaching Bolts.....	6.95 pr.



Drilled & Slotted Rotors

Drilled and slotted for maximum cooling and reduced fade; the ultimate in high performance braking and looks.

FCDR-66	1969-72*	130.99 pr.
FCDR-7377	1973-77	157.99 pr.
FCDR-78G	1978	160.99 pr.
FCDR-79G	1979-81	140.99 pr.
FCDR-82G	1982-88	160.99 pr.

*Works on 1964-72 with single piston calipers.



2 Piece Rotors

Available for the first time! All cars from 1967-72 originally came with 2 piece rotors from the factory. These 2 piece rotors duplicate the originals and are a must for a concours restoration.

FBR-2PK	1967-72 All Pair	224.98 kit
---------	------------------	------------



Rotors

New OEM style one piece rotors.

FBR-780	1967-68 4 Piston	70.99 ea.
FBR-880	1968-72 All	69.99 ea.
FBR-880KIT	1968-72 Pair	139.98 pr.
FBR-03C	1973-77 All	61.95 ea.



Rear Drum Brake Kit

This is the complete kit and all parts are plated and color coated factory correct. The best part is that it comes completely assembled ready to bolt on to the axle housing. Take the frustration out of your project with this kit.

This kit includes: Backing plates, Wheel Cylinder, Drums, Shoes, All of the hardware: Springs, Adjuster, Space bar, Special washer, Cylinder pins and parking brake lever.

DBK64R2	1964-67	425.99 kit
DBK68R2	1968-72	425.99 kit



Rear Drum Brake Rebuild Kit

This is a complete drum rebuild kit. Includes: shoes, spring kits, pins, wheel cylinder screws, parking brake levers, space bar and washers. Fits all cars with a 9 and a half inch rear drum. Does both sides.

FPK-REAR-KIT	1964-77	155.99 kit
--------------	---------	------------

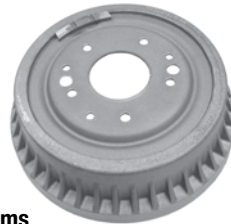

Brake Drums

Brand new finned brake drums.

FBD-95R	1964-72 Rear Finned	59.95 ea.
FD-95F	1964-72 Front Finned	59.95 ea.



Backing Plates

New replacement rear drum backing plates.

FBP-41L	All LH	64.95 ea.
FBP-41R	All RH	64.95 ea.
FBP-41K	All Kit	116.91 kit
FPB-BOLT	Retaining Bolt/Nut	0.95 ea.



Brake Hardware Kit

Correct springs, rods, retainer, adjuster and clamp for mounting shoes to car. Does 2 wheels.

FPK-1671	All Front	41.48 kit
FPK-2642	All Rear	39.87 kit
FPK-REAR-KIT	All 9.5 Drums	155.99 kit

F5-64R



Brake Shoes

Complete shoes for 2 drums.

F5-64R	All Rear	29.95 pr.
FB5-64F	All Front	32.95 pr.

FBG-17



Drum Brake Guide/Pin

FBG-17	Upper Guide Plate	5.95 ea.
FAP-2R	Attaching Pin Rear	16.99 ea.



FMC-6700

Master Cylinder Caps & Gaskets

New correct gold cadmium plated caps.

Caps

FMC-6450	1964-66 Single	24.99 ea.
FMC-6700	1967-69 Disc	16.95 ea.
FMC-6800	1970-72 Disc	16.95 ea.

Gaskets

FG-67D	1967-72 Drum	6.95 ea.
FG-67B	1967-69 Disc	8.95 ea.
FG-695	1970-72 Disc	6.95 ea.



FMR-12441

FLN-12968



FMP-12046



Master Cylinder Hardware

Master Cylinder Firewall Reinforcement Plate

Used only on manual brakes to provide support at the firewall for the master cylinder.

FMP-12046	1964-72	10.99 ea.
-----------	---------	-----------

Master Cylinder Clevis Lock Nut

Equipped on all factory manual or power disc cars to prevent the rod from spinning so that the clevis does not fall off.

FLN-12968	1964-72	2.99 ea.
-----------	---------	----------

Master Cylinder Rod Assembly

Correct master cylinder push rod assembly used when converting to manual disc or if the car is manual drum.

FMR-12441	1964-72	56.99 ea.
-----------	---------	-----------

FMP-1967C



FMP-51C

Chrome Master Cylinders

A chrome master cylinder will add a beautiful finishing detail to your engine compartment so you will be proud to pop your hood at any car show!

Chrome

FMP-1967C	1967-72 Round Disc/Drum	
	1-1/8" Bore	91.99 ea.
FMP-04C	1967-72 Round Disc/Disc	
	1" Bore	91.99 ea.
FMP-51C	1967-72 Slimline Disc/Drum	
	1-1/8" Bore	100.99 ea.
FMP-56C	1967-72 Slimline Disc/Disc	
	1" Bore	100.99 ea.

MASTER CYLINDER & BOOSTER

OEM Style Master Cylinders
Choose from a wide variety of master cylinders to suit your needs. OEM style master cylinders feature cast bodies with caps as original. Choose a master with bleeders for the ultimate in authenticity.

FMP-1362	1964-66 Single Drum	87.99 ea.
FMP-1966	1967-72 Dual Drum Power	79.99 ea.
FMP-1967	1967-69 Power Disc	74.99 ea.
FMP-069	1967-69 Power Disc w/ Bleeders	79.99 ea.
FMP-1970	1970-72 Power Disc	69.95 ea.
FMP-070	1970-72 Power Disc w/ Bleeders	77.99 ea.



Power Brake Hose Kit
OEM style hose with correct double circle Delco check valve, grommet and black phosphate clamps.

AXP-0656	1964-88	21.95 kit
----------	---------------	-----------



Brake Booster Check Valves
New replacement check valves complete with grommet.

AXP-1CV	All, White	13.99 ea.
GCS-S7800	All, Chrome	6.99 ea.



Power Booster Boot
Reproduction of this often missing boot.

FBB-3715	1968-72 All	16.95 ea.
----------	-------------------	-----------



Power Brake Tube
Correct "pre-bent" tube with bracket for cars with power brakes (high quality zinc plated as original.)

APN-7938	1964-69 All BB	41.99 ea.
APN-0270	1970 All BB	30.99 ea.
APN-71	1971-72 All BB	30.99 ea.
APN-7301	1973 350	30.99 ea.
APJ-1217	Bracket SB w/ PB	15.95 ea.

THE RIGHT Stuff

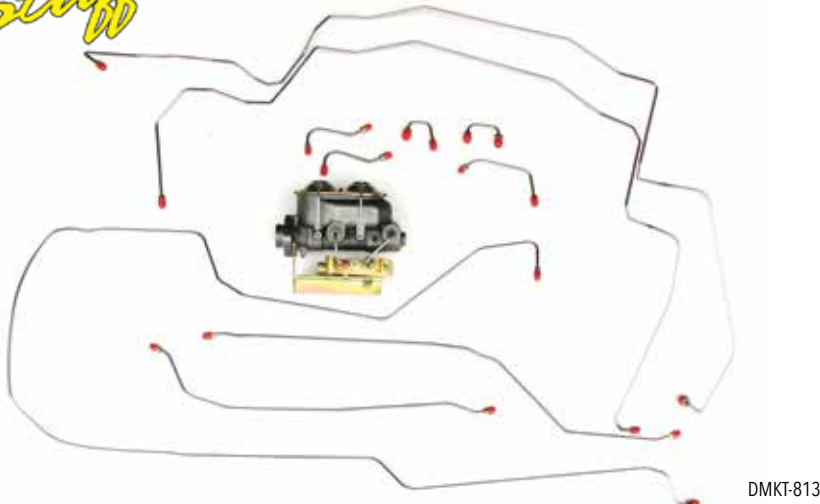

DMKT-813

Dual Master Conversion Kits

Give your pre-1967 Chevelle a dual master cylinder system. This kit separates the front brakes from the rear brakes for a much safer system. Each kit includes a distribution block, mounting bracket with hardware and a full set of pre-bent brake lines to finish the installation.

With Master Cylinder	OM	SS
DMKT-811	1964-66 Power Drum Hardtop	263.67 kit..... 302.37 kit
DMKT-812	1964-66 Power Drum Convertible	263.67 kit..... 302.37 kit
DMKT-813	1964-66 Standard Drum Hardtop	263.67 kit..... 302.37 kit
DMKT-814	1964-66 Standard Drum Convertible	263.67 kit..... 302.37 kit

BMK-9SB

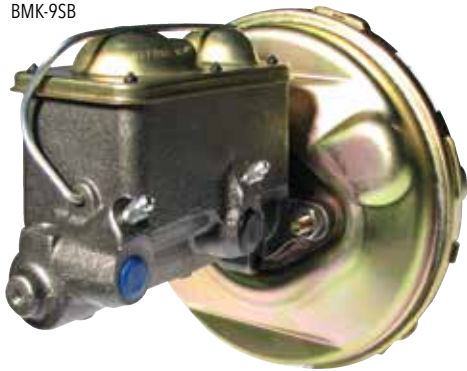

BMK-11RBD



BUY'N SAVE
WITH KITS

GM Restoration
Parts

Booster/Master Kits

Replace your old booster and master in one shot and save! These kits are available in many configurations to suit your restoration needs. If you are restoring a car to original specs, the factory style bleeder screws featured in this master cylinder are a must. The booster is available in 9" or 11" configurations and with or without the Delco Moraine stamp. 1964-69 includes round master and 1970-72 includes square master.

BMK-9R	1964-69 w/ 9" Booster	182.73 kit
BMK-11R	1964-69 w/ 11" Booster.....	182.73 kit
BMK-9RD	1964-69 w/ 9" Booster Delco Stamp.....	183.58 kit
BMK-11RD	1964-69 w/ 11" Booster Delco Stamp.....	183.58 kit
BMK-9RB	1964-69 w/ Bleeder Screws w/ 9" Booster.....	186.98 kit
BMK-11RB	1964-69 w/ Bleeder Screws w/ 11" Booster.....	186.98 kit
BMK-9RBD	1964-69 w/ Bleeder Screws w/ 9" Booster Delco Stamp.....	187.83 kit
BMK-11RBD	1964-69 w/ Bleeder Screws w/ 11" Booster Delco Stamp.....	187.83 kit
BMK-9S	1970-72 w/ 9" Booster.....	178.45 kit
BMK-11S	1970-72 w/ 11" Booster.....	178.45 kit
BMK-9SD	1970-72 w/ 9" Booster Delco Stamp.....	179.30 kit
BMK-11SD	1970-72 w/ 11" Booster Delco Stamp.....	179.30 kit
BMK-9SB	1970-72 w/ Bleeder Screws w/ 9" Booster.....	185.28 kit
BMK-11SB	1970-72 w/ Bleeder Screws w/ 11" Booster.....	185.28 kit
BMK-9SBD	1970-72 w/ Bleeder Screws w/ 9" Booster Delco Stamp.....	186.13 kit
BMK-11SBD	1970-72 w/ Bleeder Screws w/ 11" Booster Delco Stamp.....	186.13 kit

No Volume Discount.

Single Master

This booster/master kit features a single master for early Chevilles with power drum brakes. The booster comes in a 9" diameter with or without the Delco Moraine stamp.

BMK-966	9"	193.78 kit
BMK-966D	9" w/ Delco	194.63 kit

No Volume Discount.



BMK-966

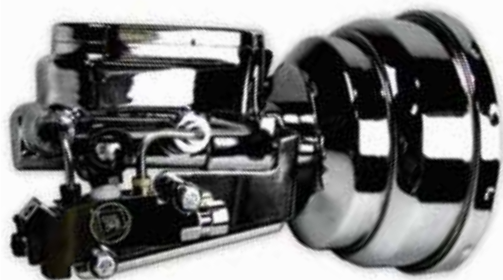

SLIM-8C-4

Slimline Booster / Master / Pro-Valve Kits

These Slimline kits allow you to replace your booster, master cylinder and proportioning valve in one simple step! All kits feature an 8" booster.

SLIM-8G-2	1964-72 Disc/Drum 8" Booster Gold.....	203.99 kit
SLIM-8G-4	1964-72 Disc/Disc 8" Booster Gold.....	203.99 kit
SLIM-8C-2	1964-72 Disc/Drum 8" Booster Chrome.....	283.99 kit
SLIM-8C-4	1964-72 Disc/Disc 8" Booster Chrome.....	283.99 kit

BMK-SHOW11R



Chrome Booster / Master / Pro Valve Kit

This show quality chrome plated power brake master cylinder and brake booster kit also includes a polished and chromed proportioning valve with stainless steel valve to master cylinder lines. This kit will be a great finishing touch for your classic Chevy.

BMK-SHOW9R	1964-72 Disc/Drum, 9" Booster.....	302.99 kit
BMK-SHOW11R	1964-72 Disc/Drum, 11" Booster.....	302.99 kit
BMK-SHOW9R4W	1964-72 Disc/Disc, 9" Booster.....	347.99 kit
BMK-SHOW11R4W	1964-72 Disc/Disc, 11" Booster.....	347.99 kit

No Volume Discount.



FBB-6



11" Delco Moraine Booster

Crafted with the same gold cadmium plating as original as well as the Delco Moraine logo stamping for the ultimate in authenticity.

FBB-6 1964-72 140.99 ea.



FBB-3



9" Delco Moraine Booster

Crafted with the same gold cadmium plating and Delco Moraine logo as our 11" booster, this 9" booster allows more clearance when running tall valve covers.

FBB-3 1964-72 140.99 ea.



FBB-6-UP



Power Booster w/ Upside Down Logo

Correct 11" power brake booster featuring the "upside down" Delco Moraine logo for the ultimate in authenticity. Gold cadmium plated. Include factory correct check valve.

FBB-6-UP 1964-72 11" 170.99 ea.



FPB-1102

11" Delco Style Booster

This is a brand new power brake booster crafted with the same gold cadmium plating as original.

FPB-1102 1964-72 139.99 ea.



FPB-9022

9" Delco Style Booster

This is a brand new power brake booster crafted with the same gold cadmium plating as original. This 9" booster allows more clearance when running tall valve covers.

FPB-9022 1964-72 139.99 ea.



FPB-1003C

Chrome Booster

This is a brand new power brake booster crafted with chrome plating to set your car apart from others.

FPB-9021C 1964-72 9" 189.99 ea.
FPB-1003C 1964-72 11" 155.99 ea.



FPB-7137C

7" Dual Slimline Booster

A good booster when room is tight. Great for big block cars with tall valve covers. Roughly the same assist as a 9" single booster.

FPB-7137 1964-72 Gold 115.99 ea.
FPB-7137C 1964-72 Chrome 157.99 ea.
FPB-7137S 1964-72 Stainless 199.99 ea.



FPB-8131

8" Dual Slimline Booster

Our most powerful Slimline booster. 10-15% more assist than a 9" single. Compact enough to fit most applications.

FPB-8131 1964-72 Gold 115.99 ea.
FPB-8131C 1964-72 Chrome 157.99 ea.



FPB-9002S

9" Single Slimline Booster

Nice clean looks and performance that won't disappoint. A good choice if you're undecided on which booster to get.

FPB-9102 1964-72 Gold 115.99 ea.



FPR-108

1967 Distribution Block

Correct block located on the driver side frame rail for all drum and disc cars.

FPR-108 1967 All 82.99 ea.



FPR-106

1968-69 Distribution Block

Correct block located on the driver side frame rail for all drum and disc cars.

FPR-106 1968-69 All 82.99 ea.



FPR-107

1970-72 Distribution Block

Correct block located on the driver side frame rail for 1970-72 drum and 1970 disc cars.

FPR-107 1970-72 All 82.99 ea.



FPR-104D

Hold Off Valve

Originally used to hold pressure to the rear brakes so the front brakes could engage a split second earlier to prevent fishtailing.

FPR-104D 1970 Disc 56.99 ea.



Proportioning Valve Bracket & Boot

Correct gold plated pro-valve bracket.

FPVB-3	1967-70 Bracket	20.95 ea.
FPV-BOOT	All Boot.....	6.95 ea.



1967-68 Pro Valve

Correct brake proportioning valve for factory original disc brakes. This valve is located under the master cylinder and includes the bracket.

FPV-114	1967-68 w/ PDB.....	84.99 ea.
---------	---------------------	-----------



1969 Pro Valve

Correct brake proportioning valve for factory original disc brakes. This valve is located under the master cylinder. Bracket & boot not included.

FPV-89	1969 w/ PDB	96.99 ea.
--------	-------------------	-----------



1970 Pro Valve

Correct brake proportioning valve for factory original disc brakes. This valve is located under the master cylinder and includes the bracket.

FPV-7	1970 w/ PDB	89.99 ea.
-------	-------------------	-----------



1971-77 Pro Valve

Exact to original concourse level proportioning valve with correct wire lead for direct replacement.

FPR-102	1971-77 w/ PDB.....	79.99 ea.
---------	---------------------	-----------



GM Style Replacement Pro Valve Kit

These are the same pro-valve kits that are used in our disc brake conversion kits to provide correct front to rear balancing. Complete with valve, bracket, hardware and brake warning light harness.

PVK-71COMBOKIT	Front Disc.....	95.95 kit
PVK-72COMBO-KIT	4 Wheel Disc.....	95.00 kit

No Volume Discount.



Chrome Pro Valve Kit

Includes a new valve, bracket, hardware and a brake warning light harness. This kit is meant for someone putting together their own non-original disc brake setup and is required for proper front to rear balancing.

PVK-71CK	Front Disc.....	120.99 kit
PVK-72CK	4 Wheel Disc	98.99 kit

Will NOT work with original lines!



1964-66 Distribution Blocks

Correct factory drum brake distribution block. It is the correct size, shape and thickness. Made of brass with a phosphate bracket.

FBLK-100	1964-65 Single Master.....	20.99 ea.
FBLK-102	1964-65 Dual Master*.....	30.99 ea.
FBLK-101	1966 Single Master	19.99 ea.
FBLK-103	1966 Dual Master*.....	33.99 ea.

*Use for dual master conversion.



1971-72 Valve Bracket

Correct reproduction of this proportioning valve bracket unique to 1971-72 Chevelles.

FBRK-04	1971-72	18.99 ea.
---------	---------------	-----------



Hurst Roll Control Line Lock

Used primarily in drag racing to provide positive locking action to the front wheels of race cars, reducing the chance of "Rolling the Lights" and producing more effective "Burn Outs" for heating up the tires. Rigorous testing has proved a 1/100,000 of a second release time and vibration tests have seen up to 30 G's applied without mechanical failure. Adaptable to most domestic and import hydraulic brake systems.

HURST-1745000	All Universal	137.99 kit
HURST-5671510	Installation Kit.....	52.99 kit

No Volume Discount.



Brake Line Clips

Correct clips for attaching hard brake lines to frame. (Tabbed clips push into frame holes.)

ELC-316	3/16" Front.....	2.99 ea.
ELC-1316	3/16" w/ Tab	2.99 ea.
ELC-1516	5/16" Main	3.99 ea.
ELC-516	5/16" w/ Tab	3.99 ea.
ELC-10P	Double Push-In	3.95 ea.
BLC-056	Clip Bolt	0.50 ea.

*Use on main line with armor shielding.



Brake Line Clip Kits - OEM

These complete brake line clip kits include all of the factory correct clips in the original colors.

INL-CAB201	1964-66 Clip Kit (9 pc.).....	26.99 kit
INL-CAB202	1967 Clip Kit (10 pc.).....	26.99 kit
INL-CAB203	1968 Clip Kit (15 pc.).....	30.99 kit
INL-CAB204	1969 Clip Kit (19 pc.).....	30.99 kit
INL-CAB205	1970 Clip Kit (19 pc.).....	30.99 kit
INL-CAB206	1971-72 Clip Kit (23 pc.).....	39.99 kit
INL-ACB202	1973-77 Clip Kit (32 pc.).....	44.99 kit
INL-ACB204	1978-88 Clip Kit (22 pc.).....	33.99 kit

BRAKE LINES & CABLES

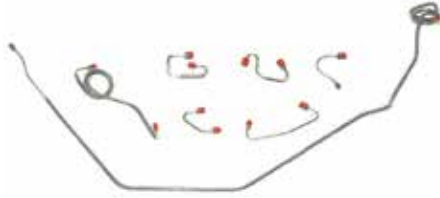

Buy a complete set of front lines, front to rear lines and rear axle lines and take 10% off. Just mention this offer to your sales rep at the time of order!



Pre-Bent Brake Lines

Our reproduction brake lines are crafted from original GM blueprints as well as from low mileage original cars. All lines feature correct double flared fittings, correct color coded nuts and correct coiled armor shields Available in original material (OM) or stainless steel (SS). These lines are for original setups only and will not fit aftermarket conversions!

Front Line Kits	OM	SS
CKT6401	1964-65 non-SS Standard Drum (3 pc.).....	41.99 kit61.99 kit
CKT6402	1964-65 non-SS Power Drum (3 pc.).....	46.99 kit61.99 kit
CKT6501	1965 SS & Z16 Standard Drum (3 pc.).....	46.99 kit66.99 kit
CKT6604	1965-66 SS & Z16 Power Drum (3 pc.).....	46.99 kit66.99 kit
CKT6601	1966 non-SS Standard Drum (3 pc.).....	46.99 kit66.99 kit
CKT6602	1966 SS & Z16 Standard Drum (3 pc.).....	46.99 kit66.99 kit
CKT6701	1967 non-SS Standard Drum (4 pc.).....	66.99 kit97.99 kit
CKT6702	1967 non-SS Power Drum (4 pc.).....	71.99 kit97.99 kit
CKT6703	1967 SS Standard Drum (4 pc.).....	66.99 kit97.99 kit
CKT6704	1967 SS Power Drum (4 pc.).....	66.99 kit97.99 kit
CKT6705	1967 SS Standard Disc (5 pc.).....	66.99 kit97.99 kit
CKT6706	1967 SS Power Disc (5 pc.).....	66.99 kit97.99 kit
CKT6801	1968 non-SS Standard Drum (6 pc.).....	66.99 kit97.99 kit
CKT6803	1968 All Power Disc (5 pc.).....	66.99 kit97.99 kit
CKT6804	1968 SS Standard Drum (6 pc.).....	66.99 kit101.99 kit
CKT6805	1968 SS Power Drum (6 pc.).....	71.99 kit97.99 kit
CKT6802	1968-72 Malibu Power Drum (6 pc.).....	66.99 kit97.99 kit
CKT6903	1969 All Power Disc (5 pc.).....	66.99 kit97.99 kit
CKT6901	1969-72 All Standard Drum (6 pc.).....	66.99 kit97.99 kit
CKT7003	1970 All Power Disc (5 pc.).....	66.99 kit97.99 kit
CKT7103	1971-72 All Power Disc (4 pc.).....	66.99 kit97.99 kit
CKT7303	1973-74 All Power Disc (4 pc.).....	66.99 kit97.99 kit
CKT7503	1975-76 All Power Disc (4 pc.).....	66.99 kit97.99 kit
CKT7703	1977 All Power Disc (4 pc.).....	66.99 kit97.99 kit

Ships Oversize.

Front to Rear Line Kits

	OM	SS
CIN6401	1964 Hardtop	51.99 kit72.99 kit
CIN6402	1964-65 Convertible.....	51.99 kit72.99 kit
CIN6402	1965 Z16, El Camino	51.99 kit72.99 kit
CIN6503	1965 Hardtop	51.99 kit72.99 kit
CIN6605	1966 Hardtop	51.99 kit72.99 kit
CIN6606	1966 Convertible, El Camino	51.99 kit72.99 kit
CIN6709	1967 Hardtop	51.99 kit72.99 kit
CIN6710	1967 Convertible, El Camino	51.99 kit72.99 kit
CIN6801	1968 Hardtop	51.99 kit72.99 kit
CIN6802	1968 Convertible	51.99 kit72.99 kit
CIN68EC	1968-69 El Camino	51.99 kit72.99 kit
CIN6815	1969 Hardtop	51.99 kit72.99 kit
CIN6816	1969 Convertible	51.99 kit72.99 kit
CIN7021	1970 Coupe Disc	51.99 kit72.99 kit
CIN7022	1970 Convertible Disc	51.99 kit72.99 kit
CIN70EC	1970 El Camino	51.99 kit72.99 kit
CIN7131	1970 Coupe Drum	51.99 kit72.99 kit
CIN7132	1970 Convertible Drum	51.99 kit72.99 kit
CIN7131	1971-72 Coupe	51.99 kit51.99 kit
CIN7104	1971-72 4 Door	51.99 kit72.99 kit
CIN7132	1971-72 Convertible.....	51.99 kit72.99 kit
CIN71EC	1971-72 El Camino	51.99 kit72.99 kit
CIN7601	1975-76 Chevelle	51.99 kit51.99 kit
CIN74EC	1974 El Camino	51.99 kit72.99 kit
CIN75EC	1975 El Camino	51.99 pr.72.99 pr.

Ships Oversize.

Rear Axle Kits

	OM	SS
CRA6403	1964-67 All (2 pc.).....	25.99 pr.36.99 pr.
CRA6803	1968-72 All (2 pc.).....	25.99 pr.36.99 pr.
CRA7303	1973-77 All (2 pc.).....	25.99 pr.36.99 pr.



Front Flex Hoses

New OEM front flex hoses exact to original.

EBH-014	1964-67 Drum	22.99 ea.
EBH-021	1968-72 Drum	21.99 ea.
EBH-26	1967 Factory Disc.....	21.99 ea.
EBH-021	1968 Factory Disc.....	21.99 ea.
EBH-020	1969-72 Disc.....	22.99 ea.
EBH-162	1973-75 All	28.99 ea.
EBH-163	1976 All	26.99 ea.
EBH-008	1977 All	21.99 ea.
EBH-164	1978 All	26.99 ea.
EBH-79	1979-88 All	26.99 ea.
EBH-003	1964-72 Front Disc Conversion Replacement	21.99 ea.

Rear Flex Hoses

New OEM rear flex hoses exact to original.

EBH-017	1964-65 All	24.99 ea.
EBH-04	1966-67 All	25.99 ea.
EBH-019	1968 All	23.99 ea.
EBH-06	1969-72 All	26.99 ea.
EBH-165	1973 All	27.99 ea.
EBH-13	1974-77 All	25.99 ea.
EBH-166	1978-88 All	26.99 ea.



Front Stainless Flex Hoses

EBH-014S	1964-67 Drum, Stainless.....	32.99 ea.
EBH-021S	1968-72 Drum, Stainless.....	32.99 ea.
EBH-26S	1967 Factory Disc, Stainless.....	32.99 ea.
EBH-021S	1968 Factory Disc, Stainless.....	32.99 ea.
EBH-020SS	1969-72 Disc, Stainless.....	34.99 ea.
EBH-162S	1973-75 All, Stainless.....	32.99 ea.
EBH-163S	1976 All, Stainless.....	32.99 ea.
EBH-008S	1977 All, Stainless.....	32.99 ea.
EBH-79BS	1979-88 All, Stainless.....	26.99 ea.
EBH-003S	1964-72 Front Disc Conversion Replacement.....	33.99 ea.

Rear Stainless Flex Hoses

EBH-017S	1964-65 All, Stainless.....	37.99 ea.
EBH-04S	1966-67 All, Stainless.....	32.99 ea.
EBH-019S	1968 All, Stainless.....	32.99 ea.
EBH-06S	1969-72 All, Stainless.....	34.99 ea.
EBH-165S	1973 All, Stainless.....	32.99 ea.
EBH-13S	1974-77 All, Stainless.....	32.99 ea.
EBH-166BS	1979-88 All, Stainless.....	32.99 ea.



Flex Hose Brackets

Correct flex hose brackets mounted at frame.

FHB-647	1964-67 Drum or Disc	23.99 pr.
FHB-03	1968 Disc 4 Piston.....	23.99 pr.
FHB-04	1964-72 Drum.....	26.99 pr.
FHB-499	1969-72 Disc.....	25.99 pr.
BLC-056	Attaching Bolt.....	0.50 ea.

EBB-691



Flex Hose Bolts

Correct OEM brake fluid bolt with hollow center and (2) special washers for attaching flex hose to caliper.

EBB-691	All w/ Disc Brakes	3.99 ea.
---------	--------------------------	----------

FHB-699



Flex Hose Bracket

Correct stamped steel bracket for retaining flex hose to rear end.

FHB-6412	1964-68 12 Bolt Rear	21.99 pr.
FHB-6410	1964-68 10 Bolt Rear	21.99 pr.
FHB-699	1969-72 All	21.99 ea.



Flex Hose Clip

Correct clip for retaining flex hose.

EBC-22 All..... 2.99 ea.

FBLK-1



Flex Hose Block

Correct brass block for rear axle hose.

FBLK-1 1966-68 All..... 16.99 ea.



Wheel Cylinders

New wheel cylinders exact to original.

FWC-09

FWC-09	1964-67 Front LH.....	34.95 ea.
FWC-10	1964-67 Front RH.....	34.95 ea.
FWC-05	1968-72 Front LH.....	35.99 ea.
FWC-06	1968-72 Front RH.....	34.99 ea.
FWC-07R	1964-69 All Rear.....	19.95 ea.
FWC-08R	1970-72 All Rear.....	19.95 ea.
BWC-100	Attaching Bolts (2).....	1.95 pr.

FCR-176



Wheel Cylinder Rods

Correct brake shoe thrust rods for engaging shoes.
(2) required per cylinder.

FCR-176 1964-72 All..... 14.99 ea.

BRH-11400



Rear Flex Hose Mounting Bolt

Correct rear brake flex hose mounting bolt which is used to secure the hose to the rear end bracket. 3/8 inch shank.

BRH-11400 1964-72..... 4.99 ea.



IBA-1495

Park Brake Assemblies

Reproduction parking brake assemblies complete with correct pad and trim.

IBA-1495B	1964-67 All.....	109.95 ea.
IBA-1495	1968-69 All.....	99.95 ea.
IBA-1495A	1970-72 All.....	99.95 ea.



FPB-12-KIT-R

Parking Brake Shoe Bar

Correct horizontal bar for activating parking brakes.

FPB-11R	1964-72 All Bar Only.....	11.99 ea.
FPB-12-KIT-R	Lever/Spring Kit RH.....	32.99 kit
FPB-12-KIT-L	Lever/Spring Kit LH.....	32.99 kit



Parking Brake Cable Super Kits

These kits include everything you need to totally replace your old parking brake cables! These kits come with (1) front cable, (1) intermediate cable, (2) rear cables, (1) cable equalizer, (2) cable connectors, (2) frame hooks, (1) crossmember hook and (3) cable retainer clips. Available in original material (OM) or stainless steel (SS).

		OM	SS
PBSUKIT-1A	1964-67 Chevelle PG, TH350, TH200-R4, 4 Speed.....	145.99 kit.....	179.99 kit
PBSUKIT-1E	1964-67 El Camino PG, TH350, TH200-R4, 4 Speed.....	139.99 kit.....	179.99 kit
PBSUKIT-2A	1964-67 Chevelle, TH400, TH700-R4, 6 Speed.....	153.99 kit.....	179.99 kit
PBSUKIT-2E	1964-67 El Camino, TH400, TH700-R4, 6 Speed.....	139.99 kit.....	179.99 kit
PBSUKIT-3A	1968-72 Chevelle PG, TH350, TH200-R4, 4 Speed.....	145.99 kit.....	189.99 kit
PBSUKIT-3E	1968-72 El Camino PG, TH350, TH200-R4, 4 Speed.....	139.99 kit.....	179.99 kit
PBSUKIT-4A	1968-72 Chevelle, TH400, TH700-R4, 6 Speed.....	145.99 kit.....	179.99 kit
PBSUKIT-4E	1968-72 El Camino, TH400, TH700-R4, 6 Speed.....	139.99 kit.....	139.99 kit

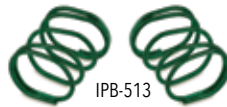

IPB-513

Parking Brake Guide Bar Springs

Correct green springs for 9.5 inch rear brakes.

IPB-513 1964-77..... 7.99 pr.

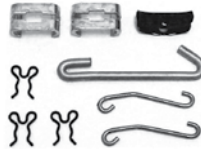

PBCK-1A

Brake Cable Support Kit

Complete kit with all hooks and clips for retaining parking brake cables.

PBCK-1A	1964-72 w/ TH400.....	21.95 kit
PBCK-2A	1964-72 w/o TH400.....	21.95 kit

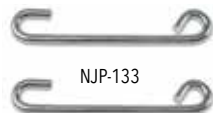

NJP-133

FJ-472

Brake Cable Guides

Correct hooks for supporting cables to crossmember.

FJ-472	1964-72 w/o TH400.....	7.95 ea.
FJ-400	1964-72 w/ TH400.....	7.95 ea.
NJP-133	1964-72 Side Body Brace.....	15.99 pr.



NJ-4675

Brake Cable Connector

Correct U shaped zinc connector for connecting intermediate cable to rear cables.

NJ-4675 1964-72 All..... 7.99 ea.



NJ-525

Brake Cable Equalizer

Correct support for connecting front cable to intermediate cable and provides equalizing tension for rear cables.

NJ-525 1964-72 All..... 4.95 ea.



NX-281

Brake Cable Retainer

Correct clip for all cars (3 required).

NX-281 1964-72 All..... 2.99 ea.