

### TRSD Performance Series Disc Brake Conversions

These all new disc brake conversions from The Right Stuff feature Wilwood 2 piston calipers, street performance brake pads, stainless braided flex hoses, spindles, caliper brackets, dust shields, proportioning valve, brake booster with master cylinder and factory size drilled and slotted rotors making for a super easy installation. These kits fit with most 15" or larger wheels.



### Street Performance Series Upgrade Featuring Wilwood Calipers

The Right Stuff Detailing's new Street Performance Series front disc brake upgrade kit is an easy way to add a nice finishing touch to your car. This kit features Wilwood dual piston black powder coated calipers, fully loaded with pads and hardware, drilled & slotted rotors and spindles. No booster, master cylinder, or pro-valve included. Installation hardware and instructions are included.

### 4 Wheel Kits

#### Non Staggered Shocks

AFXSD23CS	1962-67 Black Calipers Manual .....	1462.99 kit
AFXSD23DZ	1962-67 Red Calipers Manual .....	1462.99 kit
AFXDC23CS	1962-67 Black Calipers 9" Gold Booster .....	1525.99 kit
AFXDC23CZ	1962-67 Red Calipers 9" Gold Booster .....	1525.99 kit

#### Non Staggered Shocks 2" Drop Spindle

AFXSD23DS	1962-67 Black Calipers Manual .....	1498.99 kit
AFXSD23DZ	1962-67 Red Calipers Manual .....	1498.99 kit
AFXDC23DS	1962-67 Black Calipers 9" Gold Booster .....	1561.99 kit
AFXDC23DZ	1962-67 Red Calipers .....	1561.99 kit

#### Staggered Shocks

AFXSD25CS	1968-74 Black Calipers Manual .....	1462.99 kit
AFXSD25CZ	1968-74 Red Calipers Manual .....	1462.99 kit
AFXDC25CS	1968-74 Black Calipers 11" Gold Booster .....	1525.99 kit
AFXDC25CZ	1968-74 Red Calipers 11" Gold Booster .....	1525.99 kit
AFXSD25CSX	1968-74 Black Calipers Manual Chrome Master .....	1507.99 kit
AFXSD25CSZX	1968-74 Red Calipers Manual Chrome Master .....	1507.99 kit
AFXDC25CSX	1968-74 Black Calipers 8" Chrome Booster .....	1570.99 kit
AFXDC25CZX	1968-74 Red Calipers 8" Chrome Booster .....	1570.99 kit

#### Staggered Shocks 2" Drop Spindle

AFXSD21DS	1968-74 Black Calipers Manual .....	1498.99 kit
AFXSD21DZ	1968-74 Red Calipers Manual .....	1498.99 kit
AFXDC21DS	1968-74 Black Calipers 11" Gold Booster .....	1561.99 kit
AFXDC21DZ	1968-74 Red Calipers 11" Gold Booster .....	1561.99 kit
AFXSD25DSX	1968-74 Black Calipers Manual Chrome Master .....	1543.99 kit
AFXSD25DZX	1968-74 Red Calipers Manual Chrome Master .....	1543.99 kit
AFXDC21DSX	1968-74 Black Calipers 8" Chrome Booster .....	1606.99 kit
AFXDC21DZX	1968-74 Red Calipers 8" Chrome Booster .....	1606.99 kit

#### Front End Kits Stock Height

AFXDC32S	1968-74 Black Calipers 11" Gold Booster .....	895.99 kit
AFXDC32Z	1968-74 Red Calipers 11" Gold Booster .....	895.99 kit
AFXDC32SX	1968-74 Black Calipers 8" Chrome Booster .....	990.99 kit
AFXDC32ZX	1968-74 Red Calipers 8" Chrome Booster .....	990.99 kit

#### Front End Kits 2" Drop Spindle

AFXDC32DS	1968-74 Black Calipers 11" Gold Booster .....	931.99 kit
AFXDC32DZ	1968-74 Red Calipers 11" Gold Booster .....	931.99 kit
AFXDC32DSX	1968-74 Black Calipers 8" Chrome Booster .....	1026.99 kit
AFXDC32DZX	1968-74 Red Calipers 8" Chrome Booster .....	1026.99 kit

#### Front End Upgrade Kits

These kits come with drilled and slotted rotors, calipers, spindles and hardware.

AFXWK32S	1968-74 Black Calipers Stock Height .....	733.99 kit
AFXWK32Z	1968-74 Red Calipers Stock Height .....	733.99 kit
AFXWK32DS	1968-74 Black Calipers 2" Drop Spindle .....	774.99 kit
AFXWK32DZ	1968-74 Red Calipers 2" Drop Spindle .....	774.99 kit

These kits come with drilled and slotted rotors, loaded calipers and hardware.

RCP69S	1968-74 Black Calipers .....	614.99 kit
RCP69Z	1968-74 Red Calipers .....	614.99 kit
RCP70S	1975-78 Black Calipers .....	614.99 kit
RCP70Z	1975-78 Red Calipers .....	614.99 kit
RCP79S	1979 Black Calipers .....	614.99 kit
RCP79Z	1979 Red Calipers .....	614.99 kit

#### Rear End Kits Non Staggered Shocks

AFXRDM21S	1962-79 Black Calipers .....	652.99 kit
AFXRDM21Z	1962-79 Red Calipers .....	652.99 kit

#### Rear End Kits Staggered Shocks

AFXRDM25S	1962-79 Black Calipers .....	652.99 kit
AFXRDM25Z	1962-79 Red Calipers .....	652.99 kit

#### Rear Kits With Front Upgrade Kits

These kits come with a complete rear kit, a front kit with drilled and slotted rotors, loaded calipers and hardware.

F69RDM25S	1969-74 Black Calipers .....	1215.99 kit
F69RDM25Z	1969-74 Red Calipers .....	1215.99 kit
F70RDM25S	1975-77 Black Calipers .....	1215.99 kit
F70RDM25Z	1975-77 Red Calipers .....	1215.99 kit
F78RDM25S	1978 Black Calipers .....	1215.99 kit
F78RDM25Z	1978 Red Calipers .....	1215.99 kit

These kits ship oversize. No Volume Discount.





**Rear Disc Brake Conversion Kit**

AFXRD01

Complete rear disc brake conversion kit for the ultimate stopping power. This kit includes rotors, loaded calipers, caliper brackets, bracket hardware, flex hoses and rear brake cables. To add drilled and slotted rotors and painted calipers, add the following letters. S for black calipers, Z for red calipers. Ex. AFXRD01S is 1967-69 with black calipers. Add \$120.00 to the cost for this option.

AFXRD07_	1975-79 All	490.99 kit
AFXRD01N	1962-67 All	382.99 kit
AFXRD01NS	1962-67 All Black Calipers	490.99 kit
AFXRD01NZ	1962-67 All Red Calipers	490.99 kit
AFXRD01_	1968-74 w/o Staggered	490.99 kit
AFXRD05_S	1968-74 w/ Staggered	490.99 kit

5 lug only. No Volume Discount. Ships in multiple Oversize boxes.

**Four Wheel Power Disc Brake Conversion Kits**

Upgrade your classic to the ultimate in stopping power. Upgrade packages available -see ledger below. Our 4 wheel kits are the most complete kits in the industry at rock bottom prices. Add our No Brainer- Disc Brake line kit for a care-free installation.

Stock Height	Non-Staggered Rear Shocks	
AFXDC42C	1968-74 Nova 11" PB	895.99 kit
AFXDC42CZ	1968-74 Nova 11" PB, DS, RPC	1102.99 kit
AFXDC42CX	1968-74 Nova 8" Chrome PB	990.99 kit
AFXDC42CSX	1968-74 Nova 8" Chrome PB, DS, BPC	1170.99 kit
AFXDC42CZX	1968-74 Nova 8" Chrome PB, DS, RPC	1170.99 kit

Stock Height	Staggered Rear Shocks	
AFXDC45C	1968-74 Nova 11" PB	895.99 kit
AFXDC45CS	1968-74 Nova 11" PB, DS, BPC	1102.99 kit
AFXDC45CZ	1968-74 Nova 11" PB, DS, RPC	1102.99 kit
AFXDC45CX	1968-74 Nova 8" Chrome PB	990.99 kit
AFXDC45CSX	1968-74 Nova 8" Chrome PB, DS, BPC	1170.99 kit
AFXDC45CZX	1968-74 Nova 8" Chrome PB, DS, RPC	1170.99 kit

2" Dropped	Spindle Height Non-Staggered Rear Shocks	
AFXDC42D	1968-74 Nova 11" PB	945.99 kit
AFXDC42DS	1968-74 Nova 11" PB, DS, BPC	1152.99 kit
AFXDC42DZ	1968-74 Nova 11" PB, DS, RPC	1152.99 kit
AFXDC42DX	1968-74 Nova 8" Chrome PB	1039.99 kit
AFXDC42DSX	1968-74 Nova 8" Chrome PB, DS, BPC	1219.99 kit
AFXDC42DZX	1968-74 Nova 8" Chrome PB, DS, RPC	1219.99 kit

Staggered Rear Shocks		
AFXDC45D	1968-74 Nova 11" PB	945.99 kit
AFXDC45DS	1968-74 Nova 11" PB, DS, BPC	1152.99 kit
AFXDC45DZ	1968-74 Nova 11" PB, DS, RPC	1152.99 kit
AFXDC45DX	1968-74 Nova 8" Chrome PB	1039.99 kit
AFXDC45DSX	1968-74 Nova 8" Chrome PB, DS, BPC	1219.99 kit
AFXDC45DZX	1968-74 Nova 8" Chrome PB, DS, RPC	1219.99 kit

\*PB- Gold Power Booster, DS- Drilled & Slotted Rotors, BPC-black powder coated calipers, RPC-red powder coated calipers CH-Chrome power assembly (booster, master, pro-valve)

1962-67 w/ 5 Lug & Non Staggered Shocks		
AFXDC43C	9" PB	995.00 kit
AFXDC43CS	9" PB DS Rotors Black Calipers	1102.99 kit
AFXDC43CZ	9" PB DS Rotors Red Calipers	1102.99 kit

Fits 5 lug wheels only.



**Deluxe Disc Brake Mini Kit**

This deluxe disc brake mini kit contains essential parts to convert to your own disc brake setup or refurbish your factory set up. Includes spindles, caliper brackets, caliper backing plates, flex hoses, pro valve kit, bearing and seal kit and hardware.

FSK-69KIT	1969-74 With Single Piston Calipers	219.99 kit
-----------	-------------------------------------	------------

Can be used on 1968 when using 69-72 single piston calipers. No Volume Discount.



**Basic Disc Brake Mini Kit**

Basic kit for converting to disc brakes or restoring factory disc brake setup. Complete with 2 spindles, 2 caliper brackets, 2 caliper backing plates and 2 bolts.

FSK-X62	1962-67	166.99 kit
FSK-69	1969-74	183.30 kit

Can be used on 1968 when using 69-72 single piston calipers. No Volume Discount.

# BEST SELLER! \$AVE BIG!

## Front Power Disc Brake Conversion Kits

Upgrade your Nova today with the most complete front disc brake kit on the market. Includes all OEM parts and is available with multiple upgrades. Increase stopping power and give your car that factory stock disc brake appearance. Works with 15" wheels or larger. Includes:

- 11" rotors
- Forged spindles
- Bearings & Seals
- Loaded calipers
- Caliper brackets
- Backing plates
- Flex Hoses & Clips
- All hardware
- Master cylinder
- Power Booster (9" or 11" Gold)
- Combination valve & bracket

FM-1790X62	1962-67 Nova w/ 9" 3 Bolt Booster*	562.99 kit
FM-1790FS*	1968-74 Nova w/ 11" Booster	577.02 kit
FM-1790FS9*	1968-74 Nova w/ 9" Booster Kit	543.08 kit
* Free Upgrade- Add Drilled & Slotted Rotors- ADD - UP to Part #		
FM-1790DSF	1968-74 Nova 2" Drop Spindle-11" Booster	603.99 kit
FM-1790DSF9	1968-74 Nova 2" Drop Spindle-9" Booster	603.99 kit



# SHOW N'GO UPGRADE

This package adds drilled and slotted rotors and red or black powder coated calipers.

FM-1790FS-UP-S	D/B Kit w/ Show N Go Black	649.76 kit
FM-1790FS-UP-Z	D/B Kit w/ Show N Go Red	649.76 kit
FM-1790DSFS	2" Drop Kit-11" w/ Show N Go Black	711.99 kit
FM-1790DSFZ	2" Drop Kit-11" w/ Show N Go Red	711.99 kit



# BEST OF SHOW UPGRADE

Adds drilled & slotted rotors, 8" chrome master, booster, pro-valve assembly and powder coated calipers.

FM-1790FS-UP-SX	D/B Kit w/ Best of Show Black	724.46 kit
FM-1790FS-UP-ZX	D/B Kit w/ Best of Show Red	724.46 kit
FM-1790DSFX	2" Drop Kit- w/ Best of Show Black	783.99 kit
FM-1790DSFX	2" Drop Kit- w/ Best of Show Red	783.99 kit

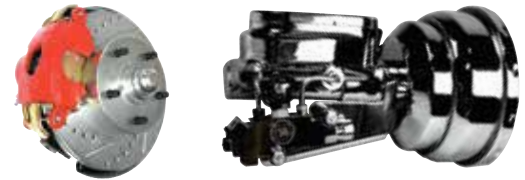

# SHOW STOPPER UPGRADE

Adds drilled & slotted rotors and a chrome master, booster, pro-valve assembly

FM-1790FS-UP-X	D/B Kit w/ Show Stopper Chrome	679.38 kit
----------------	--------------------------------	------------



## 1962-67 Four Wheel Disc Brake Conversions

Ground Up's all new four wheel disc brake conversion kits feature plain as cast, black, or red powder coated calipers, with the option for drilled & slotted rotors! This disc brake conversion kit allows you to convert to a four wheel disc setup for dramatically increased stopping power and safety. Installation hardware and instructions are included.



### Stock Height Spindles. Gold Booster.

DBK6267K	1962-67 9" PB	819.95 kit
DBK6267K-DS	1962-67 9" PB DS	799.99 kit
DBK6267K-DSB	1962-67 9" PB DS BPC	895.95 kit
DBK6267K-DSR	1962-67 9" PB DS BPC	895.95 kit
CNB67D6	1962-67 Lines OM	146.99 kit
SCNB67D6	1962-67 Lines SS	175.99 kit

DS = Drilled & Slotted Rotors  
BPC = Black Powder Coated Calipers  
RPC = Red Powder Coated Calipers

Requires the use of 5 lug 15 inch or larger wheels. Ships oversize. No volume discount.

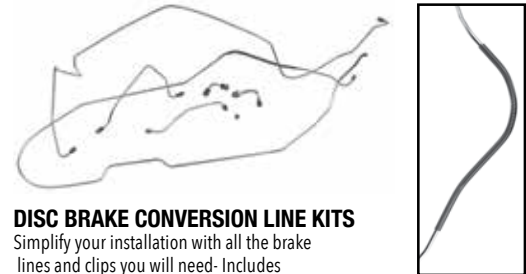

## DISC BRAKE CONVERSION LINE KITS

Simplify your installation with all the brake lines and clips you will need- Includes

- Front line kit • Front to Rear line
- Rear axle line set • Rear flex hose • Clip set

X62DCKIT_ *_*_*	1962-67 Nova	<b>Original</b> 117.99 kit
		<b>Stainless</b> 157.99 kit
X68DCKIT_ *_*_*	1968-74 Nova	<b>Original</b> 117.99 kit
		<b>Stainless</b> 157.99 kit

M Manual brakes-No Power booster used

\*4 4 wheel disc brakes \*SS for stainless steel lines

FCS68DC	1968-74 All Line Clip Kit	18.99 kit
---------	---------------------------	-----------

*Signature*  
by TRSD

THE  
**RIGHT**  
*Stuff*



**SIGNATURE\* BY TRSD 4-WHEEL DISC BRAKE CONVERSION KITS**

\*FOR 17" OR LARGER WHEELS. LIFETIME WARRANTY!!!

Bold looks define the Signature line of Brake Kits. Large diameter (13") zinc plated rotors, powder coated calipers and USA made Timken bearings: Only premium quality components make the grade. These are amazing brakes at a great price. Add the No Brainer Brake Line Kit for true bolt-in installation. Requires minimum 17" wheel. Bolts to stock drum or disc spindles.

Complete kit includes:

- 13" front drilled/slotted zinc plate rotors
- 12" rear drilled/slotted zinc plate rotors
- 2024-T6 forged aluminum hubs w/ 7/16" and 1/2" studs for multiple applications.
- Twin piston aluminum powder coated calipers- red or black
- Fully machined caliper brackets
- Ceramic brake pad
- Braided stainless steel hoses
- Integrated parking brake
- Premium quality hardware
- OEM style Master cylinder w/ Combination Valve
- Chrome Master/Booster/Valve upgrade available\*

\*PB- Gold Power Booster, DS- Drilled & Slotted Rotors, BPC-black powder coated calipers, RPC-red powder coated calipers CH-Chrome power assembly (booster, master, pro-valve)

**STOCK HEIGHT SIGNATURE KITS**

AFXDC53CS	1962-67 Nova w/ PB, DS, BPC.....	1575.99 kit
AFXDC53CZ	1962-67 Nova w/ PB, DS, RPC.....	1575.99 kit
AFXDC53CSX	1962-67 Nova w/ PB, DS, BPC, CH.....	1667.99 kit
AFXDC53CZX	1962-67 Nova w/ PB, DS, RPC, CH.....	1667.99 kit
AFXDC55CS	1968-74 Nova w/ PB, DS, BPC.....	1462.99 kit
AFXDC55CZ	1968-74 Nova w/ PB, DS, RPC.....	1462.99 kit
AFXDC55CSX	1968-74 Nova w/ PB, DS, BPC, CH.....	1557.99 kit

**2" DROPPED SPINDLE SIGNATURE KITS**

AFXDC55DS	1968-74 Nova w/ PB, DS, BPC.....	1620.99 kit
AFXDC55DZ	1968-74 Nova w/ PB, DS, RPC.....	1620.99 kit
AFXDC55DSX	1968-74 Nova w/ PB, DS, BPC, CH.....	1714.99 kit
AFXDC55DZX	1968-74 Nova w/ PB, DS, RPC, CH.....	1714.99 kit

**4 WHEEL DISC BRAKE CONVERSION LINE KITS - "NO BRAINER"**

Simplify your installation when doing a 4- wheel disc brake conversion with all the brake lines and clips you will need-

Includes Front line kit, Front to Rear line, Rear axle line set, Rear flex hoses and Clip set.

		Original	Stainless
X62DCKIT4_	1962-67 Nova 4W D/B lines .....	117.99 kit	157.99 kit
X68DCKIT4_	1968-74 Nova 4W D/B lines .....	117.99 kit	157.99 kit



**Powder Coated Calipers**

Add a nice finishing touch with these loaded calipers, complete with pads and hardware.

FRC-69FR	1969-74 Red .....	169.99 kit
FRC-69FB	1969-74 Black .....	169.99 kit
FRC-70FR	1975-77 Red .....	170.99 kit
FRC-70FB	1975-77 Black .....	170.99 kit
FRC-78FR	1978-79 Red .....	169.99 kit
FRC-78FB	1978-79 Black .....	169.99 kit



FRC4044



FRC-4059

**Single Piston Brake Calipers**

New single piston loaded calipers, complete with pads and all new hardware. Ready to install!

FRC4044	1969-74 LH .....	59.95 ea.
FRC4043	1969-74 RH .....	59.95 ea.
FRC-4060	1975-77 LH .....	61.95 ea.
FRC-4059	1975-77 RH .....	61.95 ea.
FRC-4124	1978-79 LH .....	84.95 ea.
FRC-4123	1978-79 RH .....	84.95 ea.

No Volume Discount.



FBC-4PSTL



XFC6701

**4 Piston Brake Calipers**

All new 4 piston calipers with Delco Moraine logo and casting numbers 5455530 and 5455533. Completely assembled.

FBC-4PSTL	1967-68 LH .....	236.99 ea.
FBC-4PSTR	1967-68 RH .....	236.99 ea.

No Volume Discount.

**Caliper Inlet Lines**

XFC6701	1967-68 OM .....	19.99 pr.
XFC6701SS	1967-68 SS .....	25.99 pr.



**Disc Brake Pads**

New brake pad set.

FMP-0400	1967-68 4 Piston .....	49.99 set
FMP-0200	1969-74 1 Piston .....	36.95 set



**Bearing Nut - Washer Kit**

Correct castle nut, thrust washer and cotter pin. 2 kits are required per car.

FNW-103	1968-74 All .....	4.99 kit
---------	-------------------	----------



**Bearing & Seal Kit**

New GM bearing & seal kit (2) inners, (2) outers and (2) grease seals.

FBK-67D	1968-74 All w/ Disc .....	46.53 kit
---------	---------------------------	-----------



**Bearing Cap**

Original GM bearing & dust shield cap.

FBC-605	1968-75 All (Correct Dimple) .....	18.99 ea.
FBC-99	1976-79 All .....	14.99 ea.



**Caliper Backing Plates**

OE style reproduction zinc backing plates.

FKW-4160	1967-68 4 Piston .....	70.99 pr.
FPP-11J	1969-72 Single Piston .....	39.95 pr.

No Volume Discount.



**2 Piece Rotors**

Available for the first time! All cars from 1967-72 originally came with 2 piece rotors from the factory. These 2 piece rotors duplicate the originals and are a must for a concours restoration.

FBR-2PK	1968-74 All Pair .....	224.98 kit
---------	------------------------	------------



**Rotors**

New replacement style rotors.

FBR-780	1967-68 4 Piston .....	70.99 ea.
FBR-880	1969-74 All .....	68.99 ea.
FBR-880KIT	1969-74 Pair SAVE .....	99.95 pr.
FBR-990	1975-79 All .....	69.95 ea.



FCDR-66



FCDR-7981

**Drilled & Slotted Rotors**

Drilled and slotted for maximum cooling and reduced fade; the ultimate in high performance braking and looks.

FCDR-66	1969-74* .....	130.99 pr.
FCDR-7078	1975-78 .....	160.99 pr.
FCDR-7981	1979 .....	160.99 pr.

\*Works on 1968 with single piston calipers.



**Electric Vacuum Kit**

If you have a big cam and low vacuum is making it tough for your power disc brakes to work properly, then this electric vacuum pump kit will solve your problems! A minimum of 16 inches of vacuum is critical to ensure that your power disc brakes are functioning and this kit ensures that your vacuum stays above that level so you will never have to worry about losing your brakes when you need them the most. The system automatically activates when the vacuum falls below that critical level and turns off when the engine is producing enough vacuum.

This kit includes an efficient electric pump, relay switch, distributor with vacuum switch, wiring, hoses and brackets. This system requires a 12V negative ground system for operation.

EVP01	Vacuum Pump Kit .....	267.99 kit
-------	-----------------------	------------



**Disc Brake Retaining Pin**

Correct pin for retaining 4 piston caliper brake pads to caliper. 2 required.

FBP-035	1967-68 4 Piston .....	4.99 ea.
---------	------------------------	----------



**Backing Plate Bolt**

Correct bolt for attaching plate to spindle.

BCP-373	1969-74 Single Piston .....	2.99 ea.
---------	-----------------------------	----------



**Brake Caliper Bolts**

Correct bolts/pins for mounting caliper to bracket. Two per caliper.

BMP-1000	1969-77 Single Piston .....	2.99 ea.
----------	-----------------------------	----------



**Caliper Mounting Brackets**

OE style reproduction caliper mounting brackets.

FM-155X	1967-68 4 Piston .....	133.99 pr.
FM-2501	1969-74 Single Piston .....	69.95 pr.



FSA-02

**Steering Arms**

OE style reproduction steering arms for your worn or missing originals.

FSA-02 1968-74 ..... 72.99 pr.  
Can be used on 1962-66 when converting to disc brakes.



FM-373B

FM-3712

**Spindles**

New OEM spindles

FM-X62 1962-67 Disc..... 119.00 pr.  
FM-3712 1969-72 Disc..... 72.99 ea.  
FM-1712 1969-72 Drum ..... 95.95 ea.  
FM-373B Attaching Bolts ..... 6.95 pr.



RSBK67

**Front Hose to Caliper Brackets**

Correct bracket to attach the front brake hose to the 4 piston calipers on your 1967-68 Nova.

RSBK67 1967-68 4 Piston ..... 28.99 pr.



HURST-1745000

**Hurst Roll Control Line Lock**

Used primarily in drag racing to provide positive locking action to the front wheels of race cars, reducing the chance of "Rolling the Lights" and producing more effective "Burn Outs" for heating up the tires. Rigorous testing has proved a 1/100,000 of a second release time and vibration tests have seen up to 30 G's applied without mechanical failure. Adaptable to most domestic and import hydraulic brake systems.

HURST-1745000 All Universal Roll Control..... 133.99 kit  
HURST-5671510 Installation Kit ..... 50.99 kit  
No volume discount.



FMP-1362

FMP-1966

FMP-1967

FMP-069

FMP-1970

FMP-070

**OEM Style Master Cylinders**

Choose from a wide variety of master cylinders to suit your needs. OEM style master cylinders feature cast bodies with caps. Choose a master with bleeders for the ultimate in authenticity.

FMP-1362 1962-66 Single Drum ..... 87.99 ea.  
FMP-1966 1967-74 Dual Drum ..... 79.99 ea.  
FMP-1967 1968-69 Power Disc ..... 74.99 ea.  
FMP-069 1968-69 Power Disc with Bleeders..... 79.99 ea.  
FMP-1970 1970-79 Power Disc ..... 69.95 ea.  
FMP-070 1970-79 Power Disc with Bleeders..... 77.99 ea.



FMP-1967C

FMP-51C

**Chrome Master Cylinders**

A chrome master cylinder will add a beautiful finishing detail to your engine compartment so you will be proud to pop your hood at any car show!

FMP-1967C 1967-79 Round Disc/Drum 1-1/8" Bore..... 91.99 ea.  
FMP-04C 1967-79 Round Disc/Disc 1" Bore..... 91.99 ea.  
FMP-51C 1967-79 Slimline Disc/Drum 1-1/8" Bore.. 100.99 ea.  
FMP-56C 1967-79 Slimline Disc/Disc 1" Bore ..... 100.99 ea.



NMKT813

**Dual Master Conversion Kits**

Give your pre-1967 Nova a dual master cylinder system. This kit separates the front brakes from the rear brakes for a much safer system. Each kit includes a distribution block, mounting bracket with hardware and a full set of pre-bent brake lines to finish the installation.

NMKT811 Standard Drum w/ Master .....OM 251.97 kit  
SS 290.67 kit  
NMKT813 Power Drum w/ Master.....OM 251.97 kit  
SS 290.67 kit  
RSBB07 Brass Dist Block Only ..... 94.99 kit



FMC-6700

FG-67B

**Master Cylinder Caps & Gaskets**

New correct gold cadmium plated caps.

**Caps**

FMC-6450 1962-66 Single..... 24.99 ea.  
FMC-67D 1967-74 Drum..... 18.95 ea.  
FMC-6700 1967-69 Disc ..... 16.95 ea.  
FMC-6800 1970-79 Disc ..... 16.95 ea.

**Gaskets**

FG-67D 1967-74 Drum..... 6.95 ea.  
FG-67B 1967-69 Disc ..... 8.95 ea.  
FG-695 1970-79 Disc ..... 6.95 ea.



FMR-12441

**Master Cylinder Rod Assembly**

Correct master cylinder push rod assembly used when converting to manual disc or if the car is manual drum.

FMR-12441 1968-74 ..... 56.99 ea.



FLN-12968

**Master Cylinder Clevis Lock Nut**

Equipped on all factory manual or power disc cars to prevent the rod from spinning so that the clevis does not fall off.

FLN-12968 1964-72 ..... 2.99 ea.



FMP-12046

**Master Cylinder Firewall Reinforcement Plate**

Used only on manual brakes to provide support at the firewall for the master cylinder.

FMP-12046 1968-74 ..... 10.99 ea.



BMK-9SB

**BUY'N SAVE**  
WITH KITS



**Booster/Master Kits**

Replace your old booster and master in one shot and save! These kits are available in many configurations to suit your restoration needs. If you are restoring a car to original specs, the factory style bleeder screws featured in this master cylinder are a must. The booster is available in 9" or 11" configurations and with or without the Delco Moraine stamp. 1968-69 includes round master and 1970-72 includes square master.

BMK-69GM	1967-69 11" Booster w/ Stamp OEM Style w/ Pro-valve.....	269.99 kit
BMK-9R	1968-69 with 9" Booster.....	170.83 kit
BMK-11R	1968-69 with 11" Booster.....	170.83 kit
BMK-9RD	1968-69 with 9" Booster Delco Stamp.....	183.58 kit
BMK-11RD	1968-69 with 11" Booster Delco Stamp.....	183.58 kit
BMK-9RB	1968-69 with Bleeder Screws with 9" Booster.....	175.08 kit
BMK-11RB	1968-69 with Bleeder Screws with 11" Booster.....	175.08 kit
BMK-9RBD	1968-69 with Bleeder Screws with 9" Booster Delco Stamp.....	187.83 kit
BMK-11RBD	1968-69 with Bleeder Screws with 11" Booster Delco Stamp.....	176.78 kit
BMK-9S	1970-74 with 9" Booster.....	166.55 kit
BMK-11S	1970-74 with 11" Booster.....	166.55 kit
BMK-9SD	1970-74 with 9" Booster Delco Stamp.....	179.30 kit
BMK-11SD	1970-74 with 11" Booster Delco Stamp.....	179.30 kit
BMK-9SB	1970-74 with Bleeder Screws with 9" Booster.....	173.38 kit
BMK-11SB	1970-74 with Bleeder Screws with 11" Booster.....	173.38 kit
BMK-9SBD	1970-74 with Bleeder Screws with 9" Booster Delco Stamp.....	186.13 kit
BMK-11SBD	1970-74 with Bleeder Screws with 11" Booster Delco Stamp.....	186.13 kit

No Volume Discount.



AXP-0656

**Power Brake Hose Kit**

OEM hose with correct double circle Delco check valve, gasket and black phosphate clamps.

AXP-0656	1967-74 .....	21.95 kit
----------	---------------	-----------



FBB-3715

**Power Booster Boot**

Exact reproduction of this often missing boot.

FBB-3715	1968-74 All .....	16.95 ea.
----------	-------------------	-----------



APJ-1217

APN-0270

**Power Brake Tube**

Correct "pre-bent" tube with bracket for cars with power brakes (high quality zinc plated as original).

APN-7938	1968-69 All BB.....	41.99 ea.
APN-0270	1970 All BB.....	30.99 ea.
APN-71	1971-72 All BB.....	30.99 ea.

**Power Brake Hose Bracket**

APJ-1217	Most SB w/ PB .....	15.95 ea.
----------	---------------------	-----------

BMK-SHOW11R

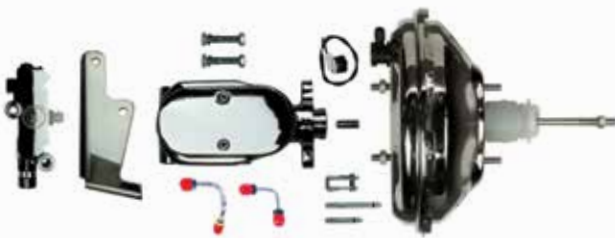

**Chrome Booster/Master/Pro Valve Kit**

This show quality chrome plated power brake master cylinder and brake booster kit also includes a polished and chromed proportioning valve with stainless steel valve to master cylinder lines. This kit will be a great finishing touch for your classic Chevy.

BMK-SHOW9R	1968-74 Disc/Drum, 9" Booster.....	302.99 kit
BMK-SHOW11R	1968-74 Disc/Drum, 11" Booster.....	302.99 kit
BMK-SHOW9R4W	1968-74 Disc/Disc, 9" Booster.....	347.99 kit
BMK-SHOW11R4W	1968-74 Disc/Disc, 11" Booster.....	347.99 kit

No Volume Discount.

SLIM-8C-2



**Slimline Booster / Master / Pro-Valve Kits**

These Slimline kits allow you to replace your booster, master cylinder, and proportioning valve in one simple step! All kits feature an 8" booster.

SLIM-8G-2	1968-74 Disc/Drum 8" Booster Gold .....	203.99 kit
SLIM-8G-4	1968-74 Disc/Disc 8" Booster Gold .....	203.99 kit
SLIM-8C-2	1968-74 Disc/Drum 8" Booster Chrome .....	283.99 kit
SLIM-8C-4	1968-74 Disc/Disc 8" Booster Chrome.....	283.99 kit
SLIM-8B-2	1968-74 Disc/Drum 8" Booster Black.....	279.95 kit
SLIM-8B-4	1968-74 Disc/Disc 8" Booster Black.....	279.95 kit



FPB-62X

**1962-67 Nova 3 Stud Booster**

This is a special 1962-1967 Chevy 2 Nova power brake booster which is specifically made to fit the 3 stud pattern on the firewall. The booster is gold cadmium plated, meaning you get better stopping power with an original look.

FPB-62X 1962-67 ..... 155.99 ea.



FPB-1003C

**Chrome Booster**

This is a brand new Nova power brake booster crafted with chrome plating to set your car apart from others.

FPB-9021C 1968-74 9" ..... 189.99 ea.  
FPB-1003C 1968-74 11" ..... 155.99 ea.



FPB-7537C

**7" Dual Slimline Booster**

A good booster when room is tight. Great for big block cars with tall valve covers. Roughly the same assist as a 9" single booster.

FPB-7137 1968-74 Gold ..... 115.99 ea.  
FPB-7137C 1968-74 Chrome ..... 157.99 ea.  
FPB-7137S 1968-74 Stainless ..... 199.99 ea.



FBB-6

**11" Delco Moraine Booster**

Crafted with the same gold cadmium plating as original, as well as the infamous Delco Moraine logo stamping for the ultimate in authenticity.

FBB-6 1968-74 ..... 140.99 ea.



FPB-1102

**11" Delco Style Booster**

This is a brand new Nova power brake booster crafted with the same gold cadmium plating as original.

FPB-1102 1968-74 ..... 125.99 ea.



FPB-8531

**8" Dual Slimline Booster**

Our most powerful Slimline booster. 10-15% more assist than a 9" single. Compact enough to fit most applications.

FPB-8131 1968-74 Gold ..... 115.99 ea.  
FPB-8131C 1968-74 Chrome ..... 157.99 ea.  
FPB-8131S 1968-74 Stainless ..... 198.99 ea.



FBB-3

**9" Delco Moraine Booster**

Crafted with the same gold cadmium plating and Delco Moraine logo as our 11" booster, this 9" booster allows more clearance when running tall valve covers.

FBB-3 1968-74 ..... 140.99 ea.



FPB-9022

**9" Delco Style Booster**

This is a brand new Nova power brake booster crafted with the same gold cadmium plating as original. This 9" booster allows more clearance when running tall valve covers.

FPB-9022 1968-74 ..... 125.99 ea.



FPB-9102

**9" Single Slimline Booster**

Nice clean looks and performance that won't disappoint. A good choice if you're undecided on which booster to get.

FPB-9102 1968-74 Gold ..... 115.99 ea.





FBB-6-UP

**11" Delco Booster w/ Upside Down Logo**

Features authentic gold cadmium plating with correct upside down Delco Moraine logo for the purist.

FBB-6-UP 1968-74 ..... 170.99 ea.



FPV-05

**1967-69 Distribution Block**

Correct brake distribution block for factory drum or disc brakes. This valve is located under the master cylinder.

FPV-05 1967-69 All ..... 85.99 ea.



FPR-110

**1970-74 Distribution Block**

Correct brake distribution block for factory drum or disc brakes. This valve is located under the master cylinder.

FPR-110 1970-74 All ..... 84.99 ea.!



FPR-104E

**1967-69 Hold Off Valve**

Originally used to hold pressure to the rear brakes so the front brakes could engage a split second earlier to prevent fishtailing.

FPR-104E 1967-69 Disc ..... 62.99 ea.



FPR-104C

**1970 Hold Off Valve**

Originally used to hold pressure to the rear brakes so the front brakes could engage a split second earlier to prevent fishtailing.

FPR-104C 1970 Disc ..... 72.99 ea.



FPR-114

**1967-68 Pro Valve**

Correct brake proportioning valve for factory original disc brakes. This valve is located under the master cylinder and includes the bracket.

FPR-114 1967-68 w/ PDB ..... 84.99 ea.



FPV89

**1969 Pro Valve**

Correct brake proportioning valve for factory original disc brakes. This valve is located under the master cylinder. Bracket not included.

FPV89 1969 w/ PDB ..... 96.99 ea.



FPV-7

**1970 Pro Valve**

Correct brake proportioning valve for factory original disc brakes. This valve is located under the master cylinder. Bracket not included.

FPV-7 1970 w/ PDB ..... 89.99 ea.



FPVB-3



FPV-BOOT

**Proportioning Valve Bracket & Boot**

Correct gold plated pro-valve bracket.

FPVB-3 1967-70 Bracket ..... 20.95 ea.  
FPV-BOOT All Boot ..... 6.95 ea.



FPR-102

**1971-77 Pro Valve**

OEM style proportioning valve with correct wire lead for direct replacement.

FPR-102 1971-77 w/ PDB ..... 79.99 ea.



FBRK-71F

**1971-77 Valve Bracket**

Correct reproduction of this proportioning valve bracket unique to 1971-77 Nova.

FBRK-71F 1971-77 ..... 23.99 ea.



PVK-71COMBOKIT

**Proportioning Valve Kit**

This is a universal proportioning valve that can be used on all cars when converting to disc brakes. Includes valve, bracket, harness and hardware. Choose from gold or chrome.

PVK-71COMBOKIT 2 Wheel Disc Gold ..... 95.95 kit  
PVK-72COMBO-KIT 4 Wheel Disc Gold ..... 95.00 kit  
PVK-71CK 2 Wheel Disc Chrome ..... 120.99 kit  
PVK-72CK 4 Wheel Disc Chrome ..... 98.99 kit  
MMC002 Brake Lines OM ..... 20.99 kit  
MMC002SS Brake Lines SS ..... 25.99 kit

No Volume Discount.



Close up of front lines

**Brake Lines Pre-Bent**

Our OE style reproduction brake lines are crafted from original GM blueprints as well as from low mileage original cars. All lines feature correct double flared fittings, correct color coded nuts and correct coiled armor shields. Available in original material (OM) or stainless steel (SS).

These lines are for original setups only and will not fit aftermarket conversions!

**Front Line Kits**

	OM	SS
XKT6201	1962-64 Manual Drum 4pc.....	56.99 kit ..... 77.99 kit
XKT6202	1962-64 Power Drum 4pc.....	56.99 kit ..... 77.99 kit
XKT6501	1965-66 Manual Drum 4pc.....	56.99 kit ..... 77.99 kit
XKT6502	1965-66 Power Drum 4pc.....	56.99 kit ..... 77.99 kit
XKT6701	1967 Manual Drum 6pc.....	66.99 kit ..... 92.99 kit
XKT6703	1967 Manual Disc 7pc.....	66.99 kit ..... 92.99 kit
XKT6704	1967 Power Disc 7pc.....	66.99 kit ..... 92.99 kit
FKT6701	1968 Manual Drum 4pc.....	60.99 kit ..... 90.99 kit
FKT6703	1968 Power Drum 4pc.....	60.99 kit ..... 90.99 kit
FKT6705	1968 Manual Disc 5pc.....	60.99 kit ..... 90.99 kit
FKT6707	1968 Power Disc 5pc.....	60.99 kit ..... 90.99 kit
XKT6905	1969 Power Disc 5pc.....	60.99 kit ..... 87.99 kit
FKT6903	1969-73 Power Drum 4pc.....	60.99 kit ..... 90.99 kit
XKT6907	1969-73 Manual Drum 4pc.....	60.99 kit ..... 87.99 kit
XKT7001	1970 Power Disc 7pc.....	71.99 kit ..... 91.99 kit
XKT7201	1971-73 Power Disc 4pc.....	60.99 kit ..... 87.99 kit
XKT7401	1974 Manual Drum 4pc.....	69.99 kit ..... 87.99 kit
XKT7501	1975 Power Disc 5pc.....	60.99 kit ..... 87.99 kit
XKT7601	1976-77 Power Disc 4pc.....	60.99 kit ..... 87.99 kit
XKT7801	1978 Power Disc 4pc.....	60.99 kit ..... 91.99 kit

*Ships Oversize*

**Front to Rear Line Kits**

	OM	SS
XIN6201	1962-65 All.....	51.99 kit ..... 72.99 kit
XIN6601	1966 L-79 Only.....	51.99 kit ..... 72.99 kit
XIN6602	1966 All.....	51.99 kit ..... 72.99 kit
XIN6701	1967 All.....	51.99 kit ..... 72.99 kit
XIN6801	1968 All.....	51.99 kit ..... 72.99 kit
XIN6901	1969 P/Disc, P/Drum.....	60.99 kit ..... 81.99 kit
XIN6902	1969-70 P/D 2pc.....	60.99 kit ..... 82.99 kit
XIN6903	1969-73 Man Drum.....	60.99 kit ..... 81.99 kit
XIN7001	1970 All Power.....	60.99 kit ..... 81.99 kit
XIN7105	1971 Power Disc.....	60.99 kit ..... 81.99 kit
XIN7103	1971-73 Power Drum.....	60.99 kit ..... 60.99 kit
XIN7201	1972-73 Power Disc.....	60.99 kit ..... 81.99 kit
XIN7402	1974 Power Disc.....	60.99 kit ..... 81.99 kit
XIN7501	1975 All Power.....	60.99 kit ..... 81.99 kit
XIN7601	1976-77 Power Disc.....	60.99 kit ..... 81.99 kit
XIN7801	1978 Power Disc.....	60.99 kit ..... 81.99 kit

*Ships Oversize 2*

**Rear Axle Kits**

XRA6202	1962-65 All.....	26.99 kit ..... 36.99 kit
XRA6602	1966-67 All.....	26.99 kit ..... 36.99 kit
FRA6802	1968 Mono Leaf.....	26.99 kit ..... 36.99 kit
FRA6805	1968 Multi Leaf.....	26.99 kit ..... 36.99 kit
XRA6902	1969-73 All.....	26.99 kit ..... 36.99 kit
XRA7402	1974 All.....	26.99 kit ..... 36.99 kit
XRA7502	1975 All.....	26.99 kit ..... 36.99 kit
XRA7601	1976-77 All.....	26.99 kit ..... 36.99 kit
XRA7801	1978 All.....	26.99 kit ..... 36.99 kit



ELC-316      ELC-1316      ELC-516



ELC-038T      ELC-10P      BLC-056

**Individual Brake Line Clips**

Correct clips for attaching hard brake lines to frame. (Tabbed clips push into frame holes.)

ELC-316	3/16" Front.....	2.99 ea.
ELC-1316	3/16" w/ Tab.....	2.99 ea.
ELC-1516	5/16" Main.....	3.99 ea.
ELC-516	5/16" w/ Tab.....	3.99 ea.
ELC-038T	3/8" w/ Tab.....	3.95 ea.
ELC-10P	Double Push-In.....	3.95 ea.
BLC-056	Clip Bolt.....	0.50 ea.
INL-14999	1975-79 Master Cylinder Line Clip... ..	12.99 ea.

*\*Use on main line with armor shielding.*

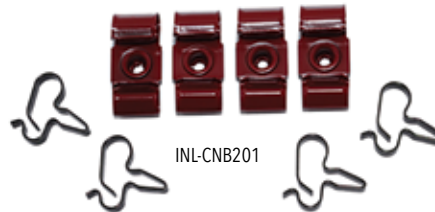

INL-CNB201

**Brake Line Clip Kits**

Complete brake line clip kits including all of the factory correct clips in the original colors.

INL-CNB201	1964-65 8pc.....	20.99 kit
INL-CNB202	1966 8pc.....	20.99 kit
INL-CNB203	1967 11pc.....	27.99 kit
INL-CNB204	1968 17pc.....	27.99 kit
INL-CNB205	1969 25pc.....	37.99 kit
INL-CNB206	1970 25pc.....	37.99 kit
INL-CNB207	1971-74 25pc.....	39.99 kit
INL-CNB208	1975-79 24pc.....	37.99 kit



INL-CNB206

**BUY'N SAVE**  
WITH KITS

Buy a complete set of front lines, front to rear lines and rear axle lines and take 10% off. Just mention this offer to your sales rep at the time of order!

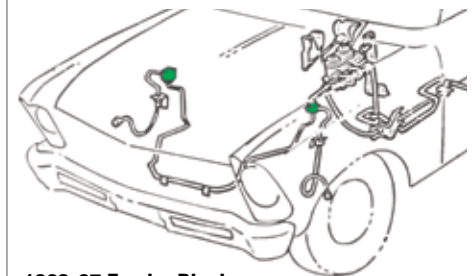

**1962-67 Fender Blocks**

Correct front flex hose fender blocks.

RSBB262	1962-1964 LH.....	16.99 ea.
RSBB265	1965-1966 LH.....	16.99 ea.
RSBB267	1967 LH.....	16.99 ea.
RSBB362	1962-1965 RH.....	17.99 ea.
RSBB366	1966 RH.....	16.99 ea.
RSBB367	1967 RH.....	16.99 ea.



EBH-05

**Front Flex Hoses**

New OEM front flex hoses exact to original.

EBH-35	1962-66 Drum .....	17.99 ea.
EBH-37	1967 Drum.....	36.99 ea.
EBH-42	1967 Factory Disc.....	36.99 ea.
EBH-012	1968-73 Drum .....	14.99 ea.
EBH-003	1969-72 Disc.....	21.99 ea.
EBH-163	1976 All.....	26.99 ea.
EBH-08	1977-78 All .....	16.99 ea.
EBH-09	1979 All.....	14.99 ea.

**Rear Flex Hoses**

New OEM rear flex hoses exact to original.

EBH-32	1962-65 All .....	16.99 ea.
EBH-04	1966-67 All .....	25.99 ea.
EBH-05	1968 All.....	25.99 ea.
EBH-06	1969-72 All .....	26.99 ea.
EBH-12	1974-75 All .....	24.99 ea.
EBH-76	1976 All.....	31.99 ea.
EBH-13	1977-79 All .....	25.99 ea.



RSBK67

**Front Hose to Caliper Brackets**

Correct bracket to attach the front brake hose to the 4 piston calipers on your 1967-68 Nova.

RSBK67	1967-68 4 Piston .....	28.99 pr.
--------	------------------------	-----------



EBB-691

**Flex Hose Bolts**

Correct OEM brake fluid bolt with hollow center and (2) special washers for attaching flex hose to caliper.

EBB-691	All w/ Disc Brakes .....	3.99 ea.
---------	--------------------------	----------



EBC-22

**Flex Hose Clip**

Correct gold cadmium plated clip for retaining flex hose.

EBC-22	All .....	2.99 ea.
--------	-----------	----------



FXB-105

**Rear Flex Hose Brackets**

Correct rear axle line flex hose brackets for the rear end.

FXB-103	1967-68 All .....	14.99 ea.
FXB-105	1969-74 12-Bolt.....	18.99 ea.
FXB-18	1969-74 10-Bolt.....	22.99 ea.



FBK-1

**Flex Hose Block**

Correct brass block for rear axle hose.

FBK-1	1966-68 All .....	16.99 ea.
-------	-------------------	-----------

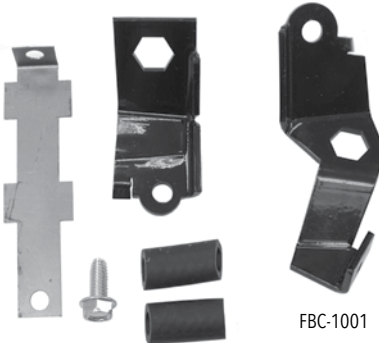

FBC-1001

**Disc Brake Flex Hose Bracket Set**

Set of three correct brackets to hold flex hoses.

FBC-1001	1969 w/ PDB .....	44.99 kit
----------	-------------------	-----------



FCR-176

**Wheel Cylinder Rods**

Correct brake shoe thrust rods for engaging shoes. (2) required per wheel cylinder.

FCR-176	1962-79 All .....	14.99 ea.
---------	-------------------	-----------



FWC-01

**Wheel Cylinders**

New OEM wheel cylinders exact to original.

FWC-24	1962-63 Front LH .....	33.99 ea.
FWC-25	1962-63 Front RH .....	33.99 ea.
FWC-26	1962-63 Rear LH .....	33.99 ea.
FWC-27	1962-63 Rear RH.....	33.99 ea.
FWC-28	1965-67 Front LH.....	34.99 ea.
FWC-29	1965-67 Front RH .....	34.99 ea.
FWC-01	1968-74 Front LH .....	19.95 ea.
FWC-02	1968-74 Front RH .....	19.95 ea.
FWC-08R	1965-79 Rear LH or RH .....	19.95 ea.
FWC-04	1976-79 Rear LH or RH .....	27.99 ea.
BWC-100	Attaching Bolts (2).....	1.95 pr.

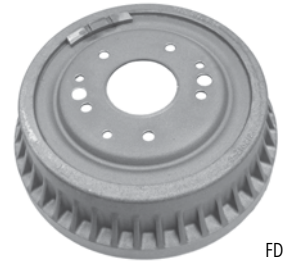

FD-95F

**Brake Drums**

Brand new finned brake drums.

FBD-95R	1962-74 Rear* .....	59.95 ea.
FD-95F	1962-74 Front* .....	59.95 ea.

\*For original 5 lug hubs or conversions only.



FBP-41L

**Backing Plates**

New replacement rear drum backing plates.

FBP-41L	All LH .....	64.95 ea.
FBP-41R	All RH .....	64.95 ea.
FBP-41K	All RH/LH .....	116.91 kit
FPB-BOLT	Retaining Bolt/Nut .....	0.95 ea.

FPK-1671



FPK-REAR-KIT



**Brake Hardware Kit**

Correct springs, rods, retainer, adjustor and clamp for mounting shoes to car. Does 2 wheels.

FPK-1671	All 1966-79 Front.....	41.48 kit
FPK-2642	All 1966-79 Rear.....	37.52 kit
FPK-REAR-KIT	All 1966-79 9.5" Drums.....	155.99 kit



F5-64R

FB5-64F

**Brake Shoes**

Complete shoes for 2 drums.

F5-64R	All Rear.....	29.95 pr.
FB5-64F	All Front.....	32.95 pr.



FAP-2R

FBG-17

**Drum Brake Guide/Pin**

FBG-17	Upper Guide Plate.....	5.95 ea.
FAP-2R	Attaching Pin Rear.....	16.99 ea.



FPB-12-KIT-R

FPB-11R

**Parking Brake Shoe Bar**

Correct horizontal bar for activating parking brakes.

FPB-11R	1968-74 All Rear .....	11.99 ea.
FPB-12-KIT-R	Lever/Spring Kit RH.....	32.99 kit
FPB-12-KIT-L	Lever/Spring Kit LH.....	32.99 kit

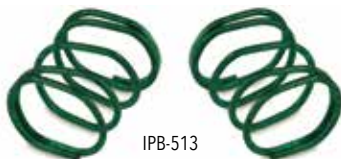

IPB-513

**Parking Brake Guide Bar Springs**

Correct green springs for 9.5 inch rear drum brakes.

IPB-513	1964-79 .....	7.99 pr.
---------	---------------	----------



NQ-397

**Parking Brake Guide**

Correct hooks for supporting cables to crossmember.

NQ-397	1968-74 All .....	7.99 ea.
NQ-X75	1975-79 All .....	12.99 ea.

**BUY 'N SAVE**  
WITH KITS



THIS IS AN  
**EXCLUSIVE**  
GROUND UP PRODUCT

**Parking Brake Cable Super Kits**

These kits include everything you need to totally replace your old parking brake cables! These kits come with (1) front cable, (1) intermediate cable (where applicable), (2) rear cables, (1) cable equalizer, (2) cable connectors, (2) frame hooks, (1) crossmember hook and (3) cable retainer clips. Available in original material (OM) or stainless steel (SS).

	OM	SS
FBSN-6401	1964-67 Kit.....	115.99 kit.....139.99 kit
FBSN-6801	1968-74 Kit.....	93.99 kit.....119.99 kit
FBSN-7501	1975-79 Kit.....	143.99 kit.....195.99 kit

No Volume Discount



NQ-93

**Brake Cable Support**

Correct rear cable support brackets which mount to the lower plates for multi leaf springs.

NQ-93	1968-74 Multi Leaf .....	23.95 ea.
-------	--------------------------	-----------



NJ-4675

**Brake Cable Connector**

Correct U shaped zinc connector for connecting intermediate cable to rear cables.

NJ-4675	1968-79 All .....	7.99 ea.
---------	-------------------	----------



NJ-525

**Brake Cable Equalizer**

Correct support for connecting front cable to intermediate cable and provides equalizing tension for rear cables.

NJ-525	1968-79 All .....	4.99 ea.
--------	-------------------	----------



NX-281

**Brake Cable Retainer**

Correct clip for all cars (3 required).

NX-281	1964-79 All .....	2.99 ea.
--------	-------------------	----------



GBL-99PC



GBL-9EB

**Parking Brake Light Switch**

Mounts on the parking brake pedal and activates the lights on your dash.

GBL-9EB	1968-74 .....	19.95 ea.
GBL-99PC	1968-74 Bracket.....	16.95 ea.



GBL-852

GBL-852-CC

**Brake Light Switches**

OE style brake light switches located above the brake pedal.

GBL-852	1962-79 All w/o Cruise Control .....	7.95 ea.
GBL-852-CC	1962-79 All w/ Cruise Control .....	19.95 ea.
GSR-12999	Retainer.....	9.99 ea.